

# ABBREVIATIONS

3PL	THIRD PARTY LOGISTICS	HOP	HAND OFF PLANE
ABS	ACRYLONITRILE BUTADIENE STYRENE	HR	HORIZONTAL
AC	AIR CONDITIONING	HT	HEIGHT
ACC	ACCESSIBLE	HVAC	HEATING VENTILATING AIR CONDITIONING
ACT	ACOUSTICAL CEILING TILE		
ADJ	ADJUSTABLE	HW	HOT WATER
AFF	ABOVE FINISHED FLOOR	IF	INSIDE DIAMETER
AHJ	AUTHORITIES HAVING JURISDICTION	IG	INSIDE INTERIOR FACE
ALUM	ALUMINUM	IG	INDEPENDENT GROUND
AMP	AMPERAGE	INSUL	INSULATION
APPROX	APPROXIMATE	INFO	INFORMATION
ARCH	ARCHITECTURAL	IW	INDIRECT WASTE
BD	BOARD	JC	JOB CAPTAIN
BLDG	BUILDING	LANDLORD	LANDLORD
BLKG	BLOCKING	MAX	MAXIMUM
BOB	BOTTOM OF BEAM	MC	MECHANICAL CONTRACTOR
BOH	BACK OF HOUSE	MDF	MEDIUM DENSITY FIBERBOARD
CAB	CABINET	MECH	MECHANICAL
CD	CONDENSATE DRAIN	MEP	MECHANICAL, ELECTRICAL AND PLUMBING
CKT	CIRCUIT	MERCH	MERCHANDISE UNIT
CLG	CEILING	MFG	MANUFACTURER
CLR	CLEAR/CLEARANCE	MIN	MINIMUM
CM	CONSTRUCTION MANAGER	MLDG	MOULDING
CMNT	CEMENT	MTL	METAL
CNU	CONCRETE MASONRY UNIT	NAT	NATURAL
CNTRS	CENTERS	NIC	NOT IN CONTRACT
CO	COMPANY	NL	NIGHT LIGHT
CL	CENTER LINE	NSF	NATIONAL SANITATION FOUNDATION
CTR	CENTER	NTS	NOT TO SCALE
COL	COLUMN	OA	OVERALL
COMP	COMPARTMENT	OC	ON CENTER
CONC	CONCRETE	OD	OUTSIDE DIAMETER
CONT	CONTINUOUS	OF	OUTSIDE FACE
CONST	CONSTRUCTION	OFI	OWNER FURNISHED ITEM
CT	CERAMIC TILE	OPNG	OPENING
CW	COLD WATER	PC	PLUMBING CONTRACTOR
CWF	COLD WATER FILTERED	PERP	PERPENDICULAR
CWN	COLD WATER NANO FILTERED	PLAM	PLASTIC LAMINATE
CWS	COLD WATER SOFTENED	PLCS	PLACES
CXFMR	CURRENT TRANSFORMER	PLXG	PLEXIGLASS
DEG	DEGREE	PLYWD	PLYWOOD
DIA	DIAMETER	PM	PROJECT MANAGER
DIM	DIMENSION	POC	POINT OF CONNECTION
DISP	DISPENSER	POS	POINT OF SALE
DN	DOWN	PT	PAINT
DT	DRIVE THRU	QT	QUARRY TILE
DTL	DETAIL	R	RADIUS
DW	DISHWASHER	RCM	RENOVATIONS CONSTRUCTION
DWG(S)	DRAWING(S)	RECEPT	RECEPTACLE
EA	EACH	REF	REFERENCE
ELEC	ELECTRICAL CONTRACTOR	REFRIG	REFRIGERATOR
ELEV	ELEVATION	REQ(D)	REQUIRE(D)
EQ	EQUAL	REV	REVISED/REVISION
EQUIP	EQUIPMENT	RND	ROUND
EXIST	EXISTING	RO	REVERSE OSMOSIS
EXP	EXPOSED	SC	SOLID CORE
EXT	EXTERIOR	SF	SQUARE FEET
FCO	FLOOR CLEANOUT	SHT	SHEET
FF&E	FURNITURE, FIXTURES & EQUIPMENT	SHT MTL	SHEET METAL
FI	FURNITURE INITIATIVES	SIM	SIMILAR
FN	FINISHED	SOL	SOLID
FIO	FURNISHED & INSTALLED BY OWNER	SPECS	SPECIFICATIONS
FIXT	FIXTURE	SQ	SQUARE
FLEX	FLEXIBLE	SS	STAINLESS STEEL
FOC	FACE OF CABINET	STG	STORAGE
FOG	FACE OF GLAZING	STRUCT	STRUCTURAL
FOH	FRONT OF HOUSE	STL	STEEL
FOIC	FURNISHED BY OWNER INSTALLED BY CONTRACTOR	SUSP	SUSPENDED
FOS	FACE OF STUD	SW	SOFTENED WATER
FRP	FIBERGLASS REINFORCED PANEL	T&G	TONGUE AND GROOVE
FLR	FLOOR	TEL	TELEPHONE
FT	FOOT/FEET	TEMP	TEMPORARY
FV	FIELD VERIFY	TW	TEMPERED WATER
GA	GAUGE	TYP	TYPICAL
GALV	GALVANIZED	UC	UNDERCOUNTER
GC	GENERAL CONTRACTOR	UN	UNLESS OTHERWISE NOTED
GRND	GROUND	VAL	VALVE
GWB	GYPSPUM WALLBOARD	VAL	VALIDATION
HC	HOLLOW CORE	VCT	VINYL COMPOSITE TILE
HD	HEAD	VD	VENDOR DIRECT
HDR	HEADER	VERT	VERTICAL
HDWD	HARDWOOD	VIF	VERIFY IN FIELD
HDWR	HARDWARE	WD	WOOD
HM	HOLLOW METAL	WH	WATER HEATER
		WMV	WHITE MAPLE VENEER
		XFMR	TRANSFORMER

# GENERAL NOTES

- GC SHALL VISIT THE SITE, REVIEW THE BUILDING SHELL DRAWINGS AS SUBMITTED BY THE LANDLORD OR STARBUCKS SITE SURVEYOR, AND BECOME THOROUGHLY FAMILIAR WITH THE SITE CONDITIONS PRIOR TO BIDDING OR CONSTRUCTION.
- GC SHALL CONSULT WITH STARBUCKS CONSTRUCTION MANAGER (CM) TO RESOLVE ANY CHANGES, OMISSIONS, OR PLAN DISCREPANCIES PRIOR TO BIDDING OR CONSTRUCTION.
- ALL WORK SHALL BE PERFORMED IN STRICT COMPLIANCE WITH LOCAL, COUNTY, STATE, AND FEDERAL CODES AND ORDINANCES.
- GC SHALL VERIFY THE LOCATION OF ALL UTILITIES.
- GC TO VERIFY ALL DIMENSIONS, INCLUDING CLEARANCES REQUIRED BY OTHER TRADES, AND NOTIFY STARBUCKS CM OF ANY DISCREPANCIES PRIOR TO PROCEEDING WITH THE WORK. ALL DIMENSIONS ARE TO THE FACE OF THE FINISHED SURFACE UNLESS NOTED OTHERWISE. ALL DIMENSIONS TO BE TAKEN FROM DESIGNATED DATUM POINT. DO NOT SCALE DRAWINGS.
- GC SHALL PATCH AND REPAIR ALL EXISTING WALLS, FLOORS, CEILINGS OR OTHER SURFACES IDENTIFIED TO REMAIN THAT MAY BECOME DAMAGED DURING THE COURSE OF THE WORK.
- THE GC IS RESPONSIBLE FOR OBTAINING PERMITS FOR FIRE PROTECTION, PLUMBING, MECHANICAL AND ELECTRICAL SYSTEMS PRIOR TO INSTALLATION OF SUCH SYSTEMS.
- GC SHALL RETAIN ONE SET OF THE PLANS TO NOTE AND DOCUMENT ALL CHANGES DURING CONSTRUCTION. THIS SET SHALL BE A PART OF THE GC'S 'STORE CLOSE-OUT PACKAGE' AS DESCRIBED IN THE CONSTRUCTION MANAGEMENT AGREEMENT.
- GC IS RESPONSIBLE FOR COORDINATING DELIVERY OF MATERIALS FROM STARBUCKS CONTRACTED THIRD PARTY LOGISTICS (3PL) DISTRIBUTION SERVICES AND VENDOR DIRECT (VD) SHIPMENTS. REFER TO CONSTRUCTION MANAGEMENT AGREEMENT FOR METHODS AND LEAD TIMES.
- RESPONSIBILITY FOR SUPPLY AND DELIVERY OF MATERIALS AND EQUIPMENT IS IDENTIFIED IN THE DRAWING SCHEDULE SHEETS UNDER THE COLUMN LABELED 'RESPONSIBILITY'. 'GC' MEANS THE ITEM IS TO BE SUPPLIED BY THE GC. '3PL' MEANS AN ITEM IS SUPPLIED BY STARBUCKS VIA STARBUCKS CONTRACTED DISTRIBUTION SERVICE AND 'VD' MEANS SUPPLIED BY STARBUCKS AND SHIPPED DIRECTLY TO THE SITE FROM THE VENDOR.
- FOR THE PURPOSE OF THE DOCUMENTS, TO 'INSTALL' SHALL MEAN TO PROVIDE ALL FASTENERS, MISCELLANEOUS HARDWARE, BLOCKING, ELECTRICAL CONNECTIONS, PLUMBING CONNECTIONS, AND OTHER ITEMS REQUIRED FOR A COMPLETE AND OPERATIONAL INSTALLATION, UON.
- ALL ITEMS SUBSTITUTION MUST BE APPROVED BY STARBUCKS DESIGN MANAGER.
- REFER TO ITEM CUTSHEETS FOR ADDITIONAL INFORMATION.
- ALL INTERIOR WOOD BLOCKING, INTERIOR WOOD STRUCTURAL MEMBERS, EXTERIOR WOOD, AND EXTERIOR PLYWOOD TO BE FIRE RETARDANT TREATED.
- FIRE SUPPRESSION AND SPRINKLER DRAWINGS TO BE COORDINATED BY GC AND SUBMITTED UNDER SEPARATE PERMIT.

# PROJECT CONTACTS

<b>MAILING ADDRESS:</b>	STARBUCKS COFFEE COMPANY 2401 UTAH AVENUE SOUTH MS STOP: S-SD10 SEATTLE, WASHINGTON 98134 (206) 318-1575 PHONE
<b>DESIGN MANAGER:</b>	CAROL KAMENISH STARBUCKS COFFEE COMPANY 6116 N. CENTRAL EXPWY, SUITE 1300 DALLAS, TX 75206 (214) 365-2216 PHONE (214) 558-4426 FAX
<b>CONSTRUCTION MANAGER:</b>	KATHY TRAVIS STARBUCKS COFFEE COMPANY 6116 N. CENTRAL EXPWY, SUITE 1300 DALLAS, TX 75206 (214) 365-2216 PHONE (214) 260-1117 FAX
<b>LANDLORD:</b>	RED DEVELOPMENT ONE E. WASHINGTON STREET, STE. 300 PHOENIX, AZ 85004 (480) 556-7731 PHONE (480) 947-7997 FAX CONTACT: DONNA HARMON
<b>MEP CONSULTANT:</b>	HENDERSON ENGINEERS, INC. 15851 DALLAS PARKWAY, SUITE 240 ADDISON, TX 75001 (972) 386-6888 PHONE (972) 386-6887 FAX CONTACT: TERESA HUSER
<b>ARCHITECT &amp; EXPEDITOR:</b>	CMA 4130 COMMERCE STREET, SUITE 105 DALLAS, TX 75226 (214) 466-1192 PHONE (214) 466-1197 FAX CONTACT: TIM LYSSY

# SITE AND OCCUPANCY

<b>CODE AUTHORITIES:</b>	CITY OF DENTON, TEXAS
<b>BUILDING CODE:</b>	2006 INTERNATIONAL BUILDING CODE W/ LOCAL AMENDMENTS
<b>PLUMBING CODE:</b>	2006 INTERNATIONAL PLUMBING CODE
<b>MECHANICAL CODE:</b>	2006 INTERNATIONAL MECHANICAL CODE
<b>ELECTRICAL CODE:</b>	2005 NATIONAL ELECTRICAL CODE
<b>FIRE CODE:</b>	2006 INTERNATIONAL FIRE CODE W/ LOCAL AMENDMENTS
<b>ENERGY CODE:</b>	2009 INTERNATIONAL ENERGY CONSERVATION CODE W/ LOCAL AMENDMENTS
<b>ACCESSIBILITY CODE:</b>	ADAAG & TAS
<b>PROJECT DESCRIPTION:</b>	TENANT IMPROVEMENTS TO AN EXISTING BUILDING
<b>ZONING:</b>	RCCD - REGIONAL CENTER COMMERCIAL DISTRICT, DOWNTOWN OVERLAY DISTRICT
<b>TYPE OF USE:</b>	COFFEE RETAIL SALES AND SERVICE
<b>TYPE OF OCCUPANCY:</b>	A-2
<b>TYPE OF CONSTRUCTION:</b>	TYPE-IB
<b>NOT SPRINKLERED</b>	
<b>TOTAL GROSS SQUARE FOOTAGE:</b>	1,850 SF
<b>OCCUPANT LOAD:</b>	
BACKBAR	407 SF /200 = 03
CAFE SEATING	
UNCONCENTRATED	= 38
FIXED	0 LF /2 = 00
SALES	238 SF /30 = 08
WORKROOM	336 SF /300 = 02
<b>TOTAL INTERIOR OCCUPANT LOAD:</b>	51
<b>TOTAL INTERIOR SEATING:</b>	=38(2 ACC)
<b>TOTAL EXTERIOR SEATING:</b>	=22(2 ACC)
<b>PLUMBING FIXTURE CALCULATION (PER TABLE 2902.1)</b>	
<b>OCCUPANT FIXTURE LOAD:</b>	51+22 = 71
<b>REQUIRED FIXTURE TO OCCUPANT RATIO:</b>	1 PER 75 (MALE/FEMALE)
<b>REQUIRED NUMBER OF FIXTURES: (MALE/FEMALE)</b>	(1/1)
<b>PROVIDED NUMBER OF FIXTURES: (MALE/FEMALE)</b>	(1/1)

# INDEX OF SHEETS

SHEET NUMBER	SHEET TITLE	
GENERAL		
G-001	PROJECT INFORMATION & CONTACTS	X
G-002	VICINITY MAP, SITE LOCATION, FOOD SERVICES PLAN	
G-003	DESIGN SPECIFICATIONS	
G-004	DESIGN SPECIFICATIONS	
G-005	PROPOSED ORDER	
G-006	PROPOSED ORDER	
G-007	PROPOSED ORDER	
ARCHITECTURAL		
A-101	SITE PLAN	
A-102	SITE DETAILS	
A-103	SITE DETAILS	
A-104	SITE DETAILS	
A-105	TRELLIS DETAILS	
A-106	TRELLIS DETAILS	
A-110	DEMOLITION FLOOR PLAN	
A-111	DEMOLITION ELEVATIONS	
A-112	PENETRATION PLAN	
A-120	FLOOR PLAN	
A-121	REFLECTED CEILING PLAN	
A-122	LIGHTING PLAN	
A-201	EXTERIOR ELEVATIONS	
A-202	EXTERIOR ELEVATIONS	X
A-501	CONSTRUCTION DETAILS	
A-502	CEILING AND LIGHTING DETAILS	
A-503	CEILING & LIGHTING DETAILS	
A-504	MISCELLANEOUS DETAILS	
A-602	DOOR DETAILS	X
A-603	STOREFRONT DETAILS	
A-604	STOREFRONT DETAILS	
INTERIORS		
I-111	FLOOR FINISH PLAN	
I-112	WALL FINISH PLAN	
I-113	CASEWORK PLANS	
I-114	FF & E PLAN	X
I-201	INTERIOR ELEVATIONS	X
I-202	INTERIOR ELEVATIONS	
I-401	ENLARGED RESTROOM PLAN & ELEVATIONS	
I-501	WALL FINISH DETAILS	X
I-502	CASEWORK DETAILS	
I-503	CASEWORK DETAILS	
I-601	FURNITURE, CASEWORK & FINISH SCHEDULES	
I-602	EQUIPMENT, SITE, SIGNAGE & CONTACT INFORMATION	
MECHANICAL		
M-001	MECHANICAL SYMBOLS AND SCHEDULES	
M-002	MECHANICAL SPECIFICATIONS	
M-003	MECHANICAL SPECIFICATIONS	
M-111	HVAC PLAN	
M-501	MECHANICAL DETAILS	
M-601	MECHANICAL ENERGY CODE CALCULATIONS	
PLUMBING		
P-001	PLUMBING SYMBOLS & SCHEDULES	X
P-002	PLUMBING SPECIFICATIONS	
P-003	PLUMBING SPECIFICATIONS	
P-112	PLUMBING SUPPLY PLAN	X
P-113	PLUMBING WASTE & VENT PLAN	
P-501	PLUMBING DETAILS	
ELECTRICAL		
E-001	ELECTRICAL SYMBOLS & GENERAL NOTES	
E-002	ELECTRICAL SPECIFICATIONS	
E-003	ELECTRICAL SPECIFICATIONS	
E-004	ELECTRICAL SPECIFICATIONS	
E-111	ELECTRICAL SITE PLAN	
E-112	LIGHTING PLAN	
E-112-EM	EMERGENCY LIGHTING PLAN	
E-113	POWER PLAN	X
E-114	LIGHTING GENERAL ILLUMINATION CALCS	
E-501	ELECTRICAL DETAILS	
E-601	ELECTRICAL RISER DIAGRAM & PANEL SCHEDULES	X
E-602	ELECTRICAL ENERGY CODE CALCULATIONS	

# SYMBOL LEGEND

	NORTH ARROW		P### - ES PAINT TAG
	EXTERIOR ELEVATION		XXXXX DESIGN ID TAG
	INTERIOR ELEVATION		XXXX DOOR / WINDOW TAG
	SECTION CALLOUT		DATUM POINT
	DETAIL CALLOUT		X'-XX" AFF ABOVE FINISHED FLOOR HEIGHT TAG
	REVISION TAG		X' - XX" DIMENSION LINE FROM FINISH FACE TO FINISH FACE
	REVISION CLOUD		WALL TYPE INDICATOR
	COLUMN GRID INDICATOR		ROOM ROOM INDICATOR

# APPROVAL STAMPS

# LEGAL DESCRIPTION

RAYZOR RANCH NORTH CONVEYANCE LOT 4R  
PROPERTY ID: 315300

# ARCHITECT'S CERTIFICATION

I HEREBY CERTIFY THAT THE PORTION OF THIS TECHNICAL SUBMISSION DESCRIBED BELOW WAS PREPARED BY ME OR UNDER MY DIRECT SUPERVISION AND RESPONSIBLE CHARGE. I AM A DULY REGISTERED ARCHITECT UNDER THE LAWS OF THE STATE OF TEXAS.

PAGES OR SHEETS COVERED BY THIS SEAL :

THE FOLLOWING ARCHITECTURAL DRAWINGS SHEETS:

G-001	A-101	A-121	A-604
G-002	A-102	A-122	I-111
G-003	A-103	A-201	I-112
G-004	A-104	A-202	I-113
	A-105	A-501	I-114
	A-106	A-502	I-201
	A-110	A-503	I-202
	A-111	A-504	I-401
	A-112	A-602	I-501
	A-120	A-603	I-502
			I-503
			I-601
			I-602



Starbucks Coffee Company  
2401 UTAH AVENUE SOUTH  
SEATTLE, WASHINGTON 98134  
(206) 318-1575

THESE PLANS AND SPECIFICATIONS, AS WELL AS STARBUCKS' NAME, LOGO, TRADEMARKS, AND DESIGNS ARE THE EXCLUSIVE PROPERTY OF STARBUCKS CORPORATION. ANY REPRODUCTION, MODIFICATION, DISCLOSURE, AND/OR USE OF THESE MATERIALS FOR ANY PORTION OF THEM WITHOUT STARBUCKS' PRIOR WRITTEN CONSENT IS STRICTLY PROHIBITED.

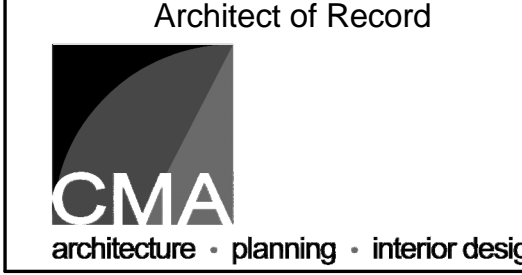

I HEREBY CERTIFY THAT THE PORTIONS OF THIS TECHNICAL SUBMISSION BEARING MY SEAL AND SIGNATURE WERE PREPARED BY ME OR UNDER MY SUPERVISION AND RESPONSIBLE CHARGE. I AM A DULY REGISTERED ARCHITECT UNDER THE LAWS OF THE STATE OF TEXAS.

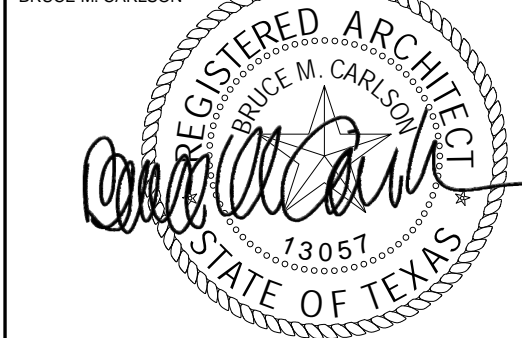

# PERMIT SET

SIGNATURE: BRUCE M. CARLSON  
DATE ISSUED: 12/23/11  
REG. NO.: 13967

ISSUE SCHEDULE			
12-23-11	PERMIT SET		
12-23-11	BID SET		
REVISION SCHEDULE			
REV#	DATE	BY	DESCRIPTION
1	02/08/12	EC	LEED, TAS, AND CITY COMMENTS

PROJECT NAME: RAYZOR RANCH  
PROJECT ADDRESS: 2320 W. UNIVERSITY DR., SUITE 1400, DENTON, TX 76210  
COUNTY: DENTON

STORE #: 16766  
CPN/PROJECT #: 54761-001  
CMA PROJECT #: 11108.034  
CONCEPT: HERITAGE  
DESIGN MANAGER: CAROL KAMENISH  
CONSTRUCTION MANAGER: KATHY TRAVIS

# PROJECT INFORMATION & CONTACTS

SHEET NUMBER: G-001

ISSUE DATE: 12/23/11



Starbucks Coffee Company

2401 UTAH AVENUE SOUTH  
SEATTLE, WASHINGTON 98134  
(206) 318-1575

THESE PLANS AND SPECIFICATIONS, AS WELL AS STARBUCKS' NAME, LOGO, TRADEMARKS, AND DESIGNS ARE THE EXCLUSIVE PROPERTY OF STARBUCKS CORPORATION. ANY REPRODUCTION, MODIFICATION, DISCLOSURE, AND/OR USE OF THESE MATERIALS OR ANY PORTION OF THEM WITHOUT STARBUCKS' PRIOR WRITTEN CONSENT IS STRICTLY PROHIBITED.

Architect of Record



I HEREBY CERTIFY THAT THE PORTIONS OF THIS TECHNICAL SUBMISSION BEARING MY SEAL AND SIGNATURE WERE PREPARED BY ME OR UNDER MY SUPERVISION AND RESPONSIBLE CHARGE. I AM A DULY REGISTERED ARCHITECT UNDER THE LAWS OF THE STATE OF TEXAS.  
BRUCE M. CARLSON



**PERMIT SET**

SIGNATURE: BRUCE M. CARLSON  
DATE ISSUED: 12/23/11  
REG. NO.: 13057

ISSUE SCHEDULE	
12-23-11	PERMIT SET
12-23-11	BID SET

REVISION SCHEDULE			
REV	DATE	BY	DESCRIPTION

PROJECT NAME: RAYZOR RANCH  
PROJECT ADDRESS: 2320 W. UNIVERSITY DENTON, TX 76201  
COUNTY: DENTON

STORE #: 16766  
CPN/PROJECT #: 54761-001  
CMA PROJECT #: 11108.034  
CONCEPT: HERITAGE  
DESIGN MANAGER: CAROL KAMENISH  
CONSTRUCTION MANAGER: KATHY TRAVIS

SHEET TITLE:  
**VICINITY MAP, SITE LOCATION, FOOD SERVICES PLAN**

SHEET NUMBER: **G-002**

ISSUE DATE: 12/23/11



**2 VICINITY PLAN**  
NOT TO SCALE

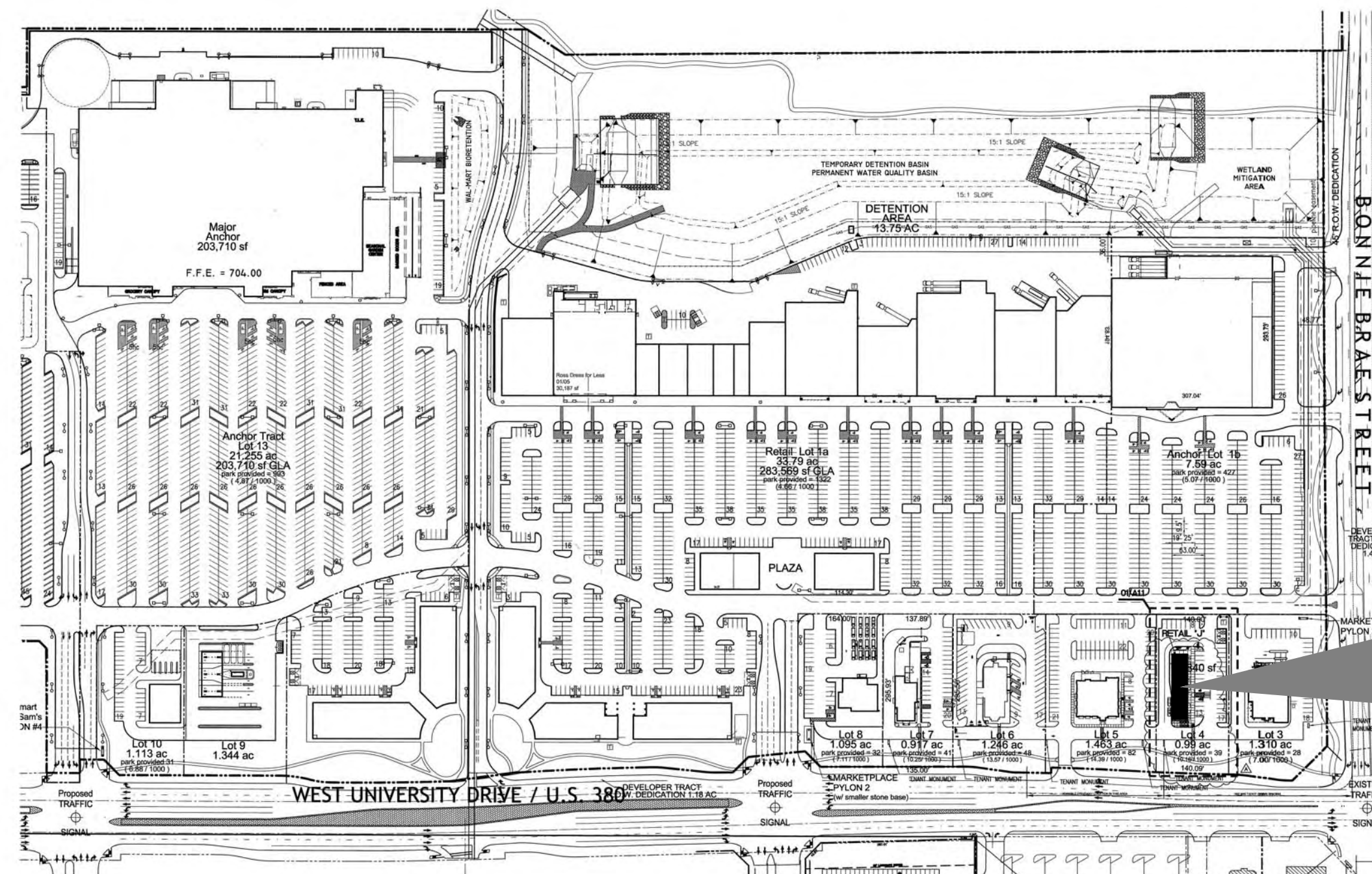

**3 SITE LOCATION**  
NOT TO SCALE

**01 SITE PLAN**

**GRAPHIC LEGEND**

- CURRENT BUILDING CONSTRUCTION
- EXISTING, FUTURE, AND BY OTHERS BUILDING CONSTRUCTION

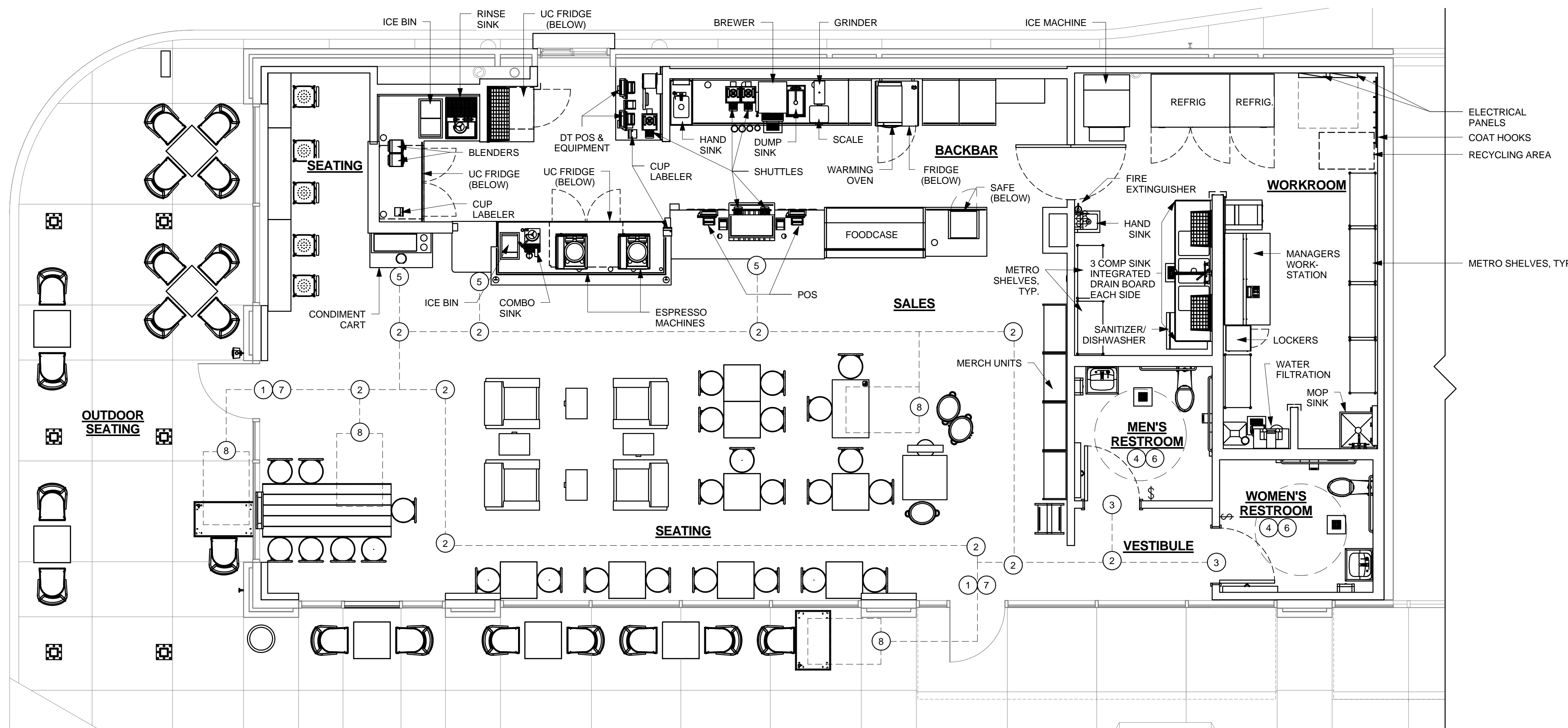

**1 FOOD SERVICES PLAN**  
Scale: 1/4" = 1'-0"

**KEYED NOTES:**

- 1 LEVEL LANDING THRESHOLD.
- 2 BARRIER-FREE PATH OF TRAVEL.
- 3 32" MINIMUM CLEAR AT RESTROOM DOOR.
- 4 60" DIAMETER CLEAR FOR WHEELCHAIR ACCESS.
- 5 POS, HAND-OFF PLANE AND CONDIMENT CART COUNTER TOPS ARE AT 2'-10" AFF FOR WHEELCHAIR ACCESSIBILITY.
- 6 SEE SHEET I-401 FOR RESTROOM DETAILS.
- 7 ALL THRESHOLDS TO BE ACC COMPLIANT PER ALL APPLICABLE CODES.
- 8 30" x 48" CLEAR FLOOR SPACE FOR WHEELCHAIR.

## General Conditions

### SECTION 01352 - SUSTAINABLE DESIGN REQUIREMENTS

- 1.1 SUMMARY
- A. This Section includes general requirements and procedures for compliance with certain U.S. Green Building Council's (USGBC) LEED prerequisites and credits.
- This project shall achieve the requirements for "Certified" LEED certification based on LEED for Retail-CI, Pilot.
  - Other LEED prerequisites and credits needed to obtain LEED certification are dependent on material selections and may not be specifically identified as LEED requirements. Compliance with requirements needed to obtain LEED prerequisites and credits may be used as one criterion to evaluate substitution requests.
  - Additional LEED prerequisites and credits needed to obtain the indicated LEED certification are dependent on the Architect's design and other aspects of the Project that are not part of the Work of the Contract.
- 1.2 DEFINITIONS
- A. Certificates of Chain-of-Custody: Certificates signed by manufacturers certifying that wood used to make products was obtained from forests certified by an FSC-accredited certification body to comply with FSC 1.2, "Principles and Criteria." Certificates shall include evidence that mill is certified for chain-of-custody by an FSC-accredited certification body.
- B. LEED: Leadership in Energy & Environmental Design.
- C. Rapidly Renewable Materials: Materials made from agricultural products that are typically harvested within a ten-year or shorter cycle. Rapidly renewable materials include products made from bamboo, cotton, flax, jute, straw, sunflower seed hulls, vegetable oils, or wool.
- D. Regionally Manufactured Materials: Materials that are manufactured within a radius of 500 miles (800 km) from the Project location. Manufacturing refers to the final assembly of components into the building product that is installed at the Project site.
- E. Regionally Extracted, Harvested, or Recovered Materials: Materials that are extracted, harvested, or recovered and manufactured within a radius of 500 miles (800 km) from the Project site.
- F. Recycled Content: The percentage by weight of constituents that have been recovered or otherwise diverted from the solid waste stream, either during the manufacturing process (pre-consumer), or after consumer use (post-consumer).
- Spills and leaks from the original manufacturing process that are combined with other constituents after a minimal amount of reprocessing for use in further production of the same product are not recycled materials.
  - Discarded materials from one manufacturing process that are used as constituents in another manufacturing process are pre-consumer recycled materials.
- 1.3 SUBMITTALS
- A. Project Materials Cost Data: Provide statement indicating total cost for materials used for Project. Costs exclude labor, overhead, and profit. Include breakout of costs for the following categories of items:
- Divisions 2-10.
  - Divisions 1, 13, and 14.
  - Division 12.
  - Plumbing.
  - Wood-based construction materials.
- B. LEED Action Plans:
- Provide preliminary submittals indicating how the following requirements will be met:
    - Submit schedule shall be based on:
      - Notice of Award.
      - Notice to Proceed.
      - Commencement of the Work.
    - Provide submittals within the following number of days after the above-selected initiation date:
      - Seven days.
      - Fourteen days.
      - Thirty days.
      - Sixty days.
  - Credit MR 2, Construction Waste Management: Provide waste management plan complying with Division 1 Section "Construction Waste Management."
  - Credit EQ 3.1, Construction IAQ Management Plan, During Construction: Proposed revisions to the Construction IAQ Plan Template complying with SMACNA IAQ Guidelines for Occupied Buildings Under Construction, 1995.
- C. LEED Progress Reports: Concurrent with each Application for Payment, submit reports comparing actual construction and purchasing activities with LEED action plans for the following:
- Waste reduction progress reports complying with Division 1 Section "Construction Waste Management."
    - Credit MR 2.1.
    - Credit MR 2.2.
- D. LEED Documentation Submittals:
- Credit WE 1, Water Use Reduction: Submit data and cut sheets for all water closets, urinals and flushometers.
  - Credit MR 2, Construction Waste Management: Submit data showing compliance with Division 1 Section "Construction Waste Management."
  - Credit EQ 3.1, Construction IAQ Management Plan, During Construction:
    - Submit product data for temporary filtration media.
    - Submit product data for filtration media used during occupancy.
    - Construction Documentation: Submit six photographs at three different occasions during construction along with a brief description of the SMACNA approach employed, documenting implementation of the IAQ management measures, such as protection of ducts and on-site stored or installed absorptive materials.
  - Credit EQ 4A, Low-Emitting Materials, Adhesives and Sealants: Submit product data for adhesives and sealants used inside the weatherproofing system, indicating VOC content of each product used. Indicate VOC content in g/L calculated according to 40 CFR 59, Subpart D.
  - Credit EQ 4B, Low-Emitting Materials, Paints and Coatings: Submit product data for paints and coatings used inside the weatherproofing system indicating VOC content of each product used. Indicate VOC content in g/L calculated according to 40 CFR 59, Subpart D.
    - Include chemical composition of each product used.
  - Credit EQ 4C, Low-Emitting Materials, Flooring: Submit product data for flooring, carpet, and cushion indicating VOC content of each product used and compliance with Carpet and Rug Institute Green Label Plus program AND hard surface flooring must be FloorScore compliant. Indicate VOC content in g/L calculated according to 40 CFR 59, Subpart D.
  - Credit EQ 4D, Low-Emitting Materials, Composite Wood: Submit product data for products containing formaldehyde wood or agrifiber products or wood glues, indicating that they do not contain urea-formaldehyde resin.
- END OF SECTION 01352

## General Conditions (Continued)

### SECTION 01420 - REFERENCES

- 1.1 INDUSTRY STANDARDS
- A. Applicability of Standards: Unless the Contract Documents include more stringent requirements, applicable construction industry standards have the same force and effect as if bound or copied directly into the Contract Documents to the extent referenced. Such standards are made a part of the Contract Documents by reference.
- B. Publication Dates: Comply with standards in effect as of date of the Contract Documents unless otherwise indicated.
- C. Copies of Standards: Each entity engaged in construction on Project should be familiar with industry standards applicable to its construction activity. Copies of applicable standards are not bound with the Contract Documents.
- Where copies of standards are needed to perform a required construction activity, obtain copies directly from publication source.
- 1.2 ABBREVIATIONS AND ACRONYMS
- A. Industry Organizations: Where abbreviations and acronyms are used in Specifications or other Contract Documents, they shall mean the recognized name of the entities in the following list.
- ACI American Concrete Institute
- AHA American Hardboard Association
- AITC American Institute of Timber Construction
- ANSI American National Standards Institute
- APA - The Engineered Wood Association
- ASHRAE American Society of Heating, Refrigerating and Air-Conditioning Engineers
- ASTM ASTM International (American Society for Testing and Materials International)
- AWI Architectural Woodwork Institute
- AWPA American Wood Protection Association (Formerly: American Wood Preservers' Association)
- CRI Carpet and Rug Institute (The)
- CRRC Cool Roof Rating Council
- CSA Canadian Standards Association
- CSA International (Formerly: IAS - International Approval Services)
- CSI Construction Specifications Institute (The)
- ETL SEMCO Intertek ETL SEMCO (Formerly: ITS - Intertek Testing Service NA)
- FM Global (Formerly: FMG - FM Global)
- FSC Forest Stewardship Council
- HPVA Hardwood Plywood & Veneer Association
- ITS Intertek Testing Service NA (Now ETL SEMCO)
- MFMA Flooring Manufacturers Association, Inc.
- MPI Master Painters Institute
- NFPA NFPA (National Fire Protection Association)
- NOFMA NOFMA: The Wood Flooring Manufacturers Association (Formerly: National Oak Flooring Manufacturers Association)
- OPL Intertak
- SDI Steel Door Institute
- SMACNA Sheet Metal and Air Conditioning Contractors' National Association
- UL Underwriters Laboratories Inc.
- USGBC U.S. Green Building Council
- WCLIB West Coast Lumber Inspection Bureau
- WI Woodwork Institute (Formerly: WIC - Woodwork Institute of California)
- B. Code Agencies: Where abbreviations and acronyms are used in Specifications or other Contract Documents, they shall mean the recognized name of the entities in the following list.
- DIN Deutsches Institut für Normung e.V.
- ICC International Code Council
- ICC-ES ICC Evaluation Service, Inc.
- C. Federal Government Agencies: Where abbreviations and acronyms are used in Specifications or other Contract Documents, they shall mean the recognized name of the entities in the following list.
- EPA Environmental Protection Agency
- D. Standards and Regulations: Where abbreviations and acronyms are used in Specifications or other Contract Documents, they shall mean the recognized name of the standards and regulations in the following list.
- ADAAG Americans with Disabilities Act (ADA)
- Architectural Barriers Act (ABA)
- Accessibility Guidelines for Buildings and Facilities
- Available from U.S. Access Board
- Code of Federal Regulations
- Available from Government Printing Office
- CFR
- END OF SECTION 01420
- SECTION 01524 - CONSTRUCTION WASTE MANAGEMENT
- 1.1 SUMMARY
- A. Salvaging nonhazardous demolition and construction waste.
- B. Recycling nonhazardous demolition and construction waste.
- C. Disposing of nonhazardous demolition and construction waste.
- 1.2 DEFINITIONS
- A. Construction Waste: Building and site improvement materials and other solid waste resulting from construction, remodeling, renovation, or repair operations. Construction waste includes packaging, demolition waste, building and site improvement materials resulting from demolition or selective demolition operations.
- B. Demolition Waste: Building and site improvement materials resulting from demolition or selective demolition operations.
- C. Disposal: Removal off-site of demolition and construction waste and subsequent sale, recycling, reuse, or deposit in landfill or incinerator acceptable to authorities having jurisdiction.
- D. Recycle: Recovery of demolition or construction waste for subsequent processing in preparation for reuse.
- E. Salvage: Recovery of demolition or construction waste and subsequent sale or reuse in another facility.
- F. Salvage and Reuse: Recovery of demolition or construction waste and subsequent incorporation into the Work.
- 1.3 PERFORMANCE REQUIREMENTS
- A. End-of-Project Rates for Salvage/Recycling:
  - 75 percent.
- 1.4 WASTE MANAGEMENT PLAN
- A. Types and quantities of demolition and construction waste.
- B. Type of waste and whether it will be salvaged, recycled, or disposed of in landfill or incinerator.
- C. Net additional cost or net savings resulting from waste management plan.
- 1.5 LEED SUBMITTALS
- A. Waste Reduction Progress Reports: Concurrent with each Application for Payment, submit completed reporting template.
- B. Indicate receipt and acceptance of waste material by accepting and processing facilities licensed to accept them. Include manifests, type of material, weight tickets, receipts, and invoices.
- 1.6 RECYCLING WASTE
- A. Recycling Incentives: Revenues and other incentives for recycling will accrue to Owner.
- END OF SECTION 01524

## Site Construction

### SECTION 02225 - CUTTING AND PATCHING

- 1.1 SUMMARY
- A. Cutting and patching required by the following:
  - Installation of other materials.
  - Finishing.
  - Alterations.
  - Tests and inspections.
  - Remodeling.
- 1.2 QUALITY ASSURANCE
- A. Limitations on Cutting and Patching:
  - Structural Elements: Do not cut or alter any existing structural elements without notifying the Architect in advance.
  - Other Elements: Unless specifically noted on the drawings to be modified, do not cut, alter, or remove existing building elements.
  - Visual Requirements: If patching operations are unable to match existing elements which are to remain or if modifications will adversely affect aesthetic qualities, notify the Architect prior to making any alteration.
- 1.3 WARRANTY
- A. Existing Warranties: Notify the Architect of existing warranties affected by cutting and patching prior to performing any modification.
- 1.4 MATERIALS
- A. In-Place Materials: Unless otherwise noted, all new materials and finishes shall match existing which are to remain.
- 1.5 EXECUTION
- A. Temporary support: Take all necessary measures to support existing elements prior to cutting, and maintain temporary support until permanent support is fully functional.
- B. Existing Utility Series and Mechanical/Electrical Systems: Ascertain the possible interruption of services to existing facilities prior to cutting existing utility lines.
- C. Patching: Perform patching operations to ensure that new materials blend seamlessly with existing.
- END OF SECTION 02225

## Concrete

### SECTION 03300 - CAST-IN-PLACE CONCRETE

- 1.1 SUMMARY
- A. Cast-in-place concrete, including formwork, reinforcement, concrete materials, mixture design, placement procedures, and finishes, for the following:
  - Patching the existing concrete slab and foundation elements where portions are removed to accommodate new work.
  - Patching or replacing concrete site improvements that are cut or remodeled.
  - Installing concrete foundations for exterior signs. Signs to be furnished and installed by others.
- B. Hydraulic-cement-based underlayment and overlayment.
- 1.2 SUBMITTALS
- A. Product Data: For each type of product indicated.
- B. Shop Drawings:
  - Reinforcing:
    - Detail reinforcing in accordance with ACI 315. Indicate reinforcement sizes, spacings, locations and quantities of reinforcing, bending and cutting schedules, splicing, and supporting and spacing devices.
    - Indicate embedded items.
  - Design Mixtures: For each concrete mixture. Submit alternate design mixtures when characteristics of materials, project conditions, weather, test results, or other circumstances warrant adjustments.
    - Indicate amounts of mixing water to be withheld for later addition at Project site.
    - Certifications: Submit mill certificates for cement, aggregates, and reinforcing.
- 1.3 MATERIALS
- A. Steel Reinforcement:
  - Reinforcing Bars: Deformed, complying with ASTM A 615.
    - Use salvaged bars whenever available.
    - Minimum recycled content: 60%.
  - Plain-Steel Welded Wire Reinforcement: ASTM A 185, plain, fabricated from as-drawn steel wire into flat sheets.
- B. Concrete Materials:
  - Portland Cement: ASTM C 150, Type I, gray, supplemented with 50% fly ash or ground granulated blast-furnace slag.
  - Aggregate: Normal weight.
  - Water: Potable.
  - Admixtures: Provide admixtures certified by manufacturer to be compatible with other admixtures and that will not contribute water-soluble chloride ions exceeding those permitted in hardened concrete. Do not use calcium chloride or admixtures containing calcium chloride.
    - Air-Entrainment: ASTM C 260.
    - Water-Reducing Admixture: ASTM C 494/C 494M, Type A.
    - High-Range, Water-Reducing Admixture: ASTM C 494/C 494M, Type F.
    - High-Range, Water-Reducing and Retarding Admixture: ASTM C 494/C 494M, Type G.
    - Accelerator ASTM C 494, Type C or E, non-corrosive, non-chloride.
- C. Fiber Reinforcement: Synthetic, polypropylene.
  - Fibrillated polypropylene micro-fibers engineered and designed for use in concrete, complying with ASTM C 1116/C 1116M, Type III
- D. Waterstops: Flexible rubber.
- E. Plastic Vapor Retarder: ASTM E 1745, Class A. Include manufacturer's recommended adhesive or pressure-sensitive joint tape.
- F. Curing Materials: Waterborne, monomolecular film forming, manufactured for application to fresh concrete.
- G. Related Materials:
  - Expansion- and isolation-joint-filler strips ASTM D 1751, asphalt-saturated cellulosic fiber or ASTM D 1752, cork or self-expanding cork.
  - Bonding Agent: ASTM C 1059/C 1059M, Type II, non-redispersible, acrylic emulsion or styrene butadiene.
  - Non-Shrink Grouts: ASTM C 1107, Grade B; non-shrink non-catalyzed natural aggregate grout; minimum compressive strength of 7000 PSI at 28 days; 25 to 30 second flow when tested in accordance with ASTM C 939 at 45 to 90 degrees F; cement gray in color Form Release Coating: Water based type; VOC <150g/L; Nox-Crete "Utility Release. Cresset Chemical Company Crete 20\_VOC," or approved; non-staining.
- H. Repair Materials:
  - Repair Underlayment and Overlayment: Cement-based, polymer-modified, self-leveling product that can be applied in thicknesses from 1/8 inch (3.2 mm) and that can be feathered at edges to match adjacent floor elevations.
    - Cement Binder: ASTM C 150, portland cement or hydraulic or blended hydraulic cement as defined in ASTM C 219.
    - Aggregate: Well-graded, washed gravel, 1/8 to 1/4 inch (3.2 to 6 mm) or coarse sand as recommended by underlayment manufacturer.
    - Compressive Strength: At 28 days when tested according to ASTM C 109/C 109M.
      - Underlayment: Not less than 4100 psi (29 MPa).
      - Overlayment: Not less than 5000 psi (34.5 MPa).
  - Primer: Product of underlayment/overlayment manufacturer recommended for substrate, conditions, and application.
    - VOC content: 200 g/L or less when calculated according to 40 CFR 59, Subpart D.
- 1.4 INSTALLATION
- A. Floor and Slab Finishes: Produce finishes that blend well with existing finishes.
- B. Underlayment/ Overlayment: Install materials in strict accordance with manufacturer's written instructions to provide smooth level surfaces, ready to receive floor finish materials.
- 1.5 FIELD QUALITY CONTROL
- A. Testing: By Owner-engaged agency.
- B. Inspections: By Owner-engaged special inspector.
- END OF SECTION 03300
- SECTION 03350 - CONCRETE FINISHING
- 1.1 SUMMARY
- A. Section Includes:
  - Concrete Sealer
  - Colored Concrete Sealer.
- 1.2 SUBMITTALS
- A. Product Data: Submit manufacturer's product data for all proposed products.
- B. Qualification Data: Submit sealer manufacturer's approval of the Applicator.
- C. Maintenance Data: Submit data to include in maintenance manuals.
- D. Warranty: Special warranties specified in this Section
- 1.3 WARRANTY
- A. Special Warranty: Manufacturer's standard form in which manufacturer agrees to repair or replace color sealer that fail(s) in materials or workmanship within specified warranty period.
  - Warranty Period: Five years from date of Substantial Completion.
- 1.4 MANUFACTURERS
- A. Manufacturers: Subject to compliance with requirements, provide products by one of the following:
  - SealSource, L.C.
  - Ameripolish
- 1.5 CONCRETE SEALER
- A. VOC Content: Liquid floor treatments shall have a VOC content of 200 g/L or less when calculated according to 40 CFR 59, Subpart D (EPA Method 24).
- B. Clear Sealer:
  - SealSource Harden X Salt Guard
  - Ameripolish Proguard Stain Shield
- C. Colored Sealer:
  - SealSource Kroma Polish.
  - Ameripolish Solvent Based Dye.
- 1.6 PREPARATION
- A. Inspect existing slab for excessive cracking, spalling, or rock pockets. Clean deficient areas and patch with an all-purpose, non-shrink, cementitious grout.
- B. Aggressively grind concrete to expose large aggregate.
- 1.7 APPLICATION
- A. Apply materials in strict accordance with manufacturer's printed instructions.
- END OF SECTION 03350

## Metals

### SECTION 05500 - METAL FABRICATIONS

- 1.1 SUMMARY
- A. Steel framing and supports for mechanical and electrical equipment.
- B. Miscellaneous steel framing and supports for applications where framing and supports are not specified in other Sections.
- C. Steel bollards.
- D. Miscellaneous stainless steel items.
- 1.2 SUBMITTALS
- A. Product Data: For the following:
  - Paint products.
  - All prefabricated products.
- B. Shop Drawings: Submit fabrication and installation details for metal fabrications.
  - Show anchorage and accessory items.
  - Provide templates for anchors and bolts specified for installation.
- C. Welding certificates.
- 1.3 PRODUCTS
- A. Steel plates, shapes, and bars, steel pipe, slotted channel framing, complying with ASTM A 36. Provide standard steel shapes with a minimum recycled content of 60 percent.
- B. Stainless Steel: Sheet material complying with ASTM A 666, Type 304, No.6 matte finish.
- C. Miscellaneous Framing and Supports:
  - Galvanize where indicated.
  - All Other: Prime with zinc-rich primer.
- D. Steel Bollards: Schedule 40 steel pipe.
- 1.4 FABRICATION AND INSTALLATION
- A. Fabricate items as detailed or as required to provide the function required.
- B. For items that remain exposed, grind all joints and surface imperfections smooth.
- C. Install items plumb and level, securely attached to other construction.
- END OF SECTION 05500

## Wood and Plastics

### SECTION 06110 - WOOD FRAMING

- 1.1 SUMMARY
- A. Wood blocking.
- B. Framing of room divider.
- C. Framing of Drive Thru trellis.
- 1.2 MATERIALS
- A. Wood-Preservative-Treated Lumber:
  - Preservative Treatment: AWPAC C2 with chemicals containing no arsenic or chromium.
    - AWPAC C31 (inorganic boron) may be used in protected locations.
  - Application: Items indicated and as follows:
    - Items in contact with roofing or waterproofing.
    - Items in contact with concrete or masonry.
    - Floor plates installed over concrete slabs-on-grade.
- B. Fire-Retardant-Treated Materials:
  - Interior Type A: Treated materials shall have a moisture content of 28 percent or less when tested according to ASTM D 3201 at 92 percent relative humidity.
  - Application: Items indicated and as follows:
    - Concealed blocking.
    - Interior framing.
- C. Dimension Lumber Framing: For items of dimension lumber size, provide Construction or No. 2 grade lumber with 19 percent maximum moisture content of any species.
- D. Fasteners: Hot-dip galvanized steel where exposed to weather, in ground contact, in contact with treated wood, or in area of high relative humidity.
- END OF SECTION 06110
- SECTION 06402 - INTERIOR ARCHITECTURAL WOODWORK
- 1.1 SUMMARY
- A. Installation of items provided by Others including, but not limited to:
  - Interior standing and running trim.
  - Flush wood paneling and wainscots.
  - Cabinets.
  - Solid-surfacing-material countertops.
- 1.2 MATERIALS
- A. General: Do not use products that contain urea formaldehyde.
- B. Wood Products:
  - Provide miscellaneous products required for a complete installation.
  - Provide products equal to and compatible with items provided by Others.
- C. Volatile Organic Compound (VOC) Limit: Use installation products that comply with the following limits for VOC content when calculated according to 40 CFR 59, Subpart D (EPA Method 24):
  - Construction Adhesive: 70 g/L.
  - Wood Adhesive: 30 g/L.
  - Contact Adhesive: 80 g/L.
- D. Shop Finishing: All items shall be shop finished.
- 1.3 INSTALLATION
- A. Scribe and cut millwork to fit adjoining work, refinish cut surfaces, and repair damaged finish at cuts.
- B. Anchor millwork to anchors or blocking built in or directly attached to substrates. Secure with countersunk, concealed fasteners and blind nailing as required for complete installation. Use fine finishing nails or finishing screws for exposed fastening, countersunk and filled flush with millwork and matching final finish if transparent finish is indicated.
- C. Cabinets: Install without distortion so doors and drawers fit openings properly and are accurately aligned. Adjust hardware to center doors and drawers in openings and to provide unencumbered operation. Complete installation of hardware and accessory items as indicated.
  - Install cabinets with no more than 1/8 inch in 96-inch (3 mm in 2400-mm) sag, bow, or other variation from a straight line.
- D. Countertops: Anchor securely by screwing through corner blocks of base cabinets or other supports into underside of countertop.
  - Align adjacent solid-surfacing-material countertops and form seams to comply with manufacturer's written recommendations using adhesive in color to match countertop. Carefully dress joints smooth, remove surface scratches, and clean entire surface.
  - Install countertops with no more than 1/8 inch in 96-inch (3 mm in 2400-mm) sag, bow, or other variation from a straight line.
  - Secure covered backsplashes to tops and to walls with adhesive per manufacturer's fabrication manual.
  - Caulk space between backsplash and wall with sealant specified in Division 7 Section "Joint Sealants."

### END OF SECTION 06110

### SECTION 06402 - INTERIOR ARCHITECTURAL WOODWORK

- 1.1 SUMMARY
- A. Installation of items provided by Others including, but not limited to:
  - Interior standing and running trim.
  - Flush wood paneling and wainscots.
  - Cabinets.
  - Solid-surfacing-material countertops.
- 1.2 MATERIALS
- A. General: Do not use products that contain urea formaldehyde.
- B. Wood Products:
  - Provide miscellaneous products required for a complete installation.
  - Provide products equal to and compatible with items provided by Others.
- C. Volatile Organic Compound (VOC) Limit: Use installation products that comply with the following limits for VOC content when calculated according to 40 CFR 59, Subpart D (EPA Method 24):
  - Construction Adhesive: 70 g/L.
  - Wood Adhesive: 30 g/L.
  - Contact Adhesive: 80 g/L.
- D. Shop Finishing: All items shall be shop finished.
- 1.3 INSTALLATION
- A. Scribe and cut millwork to fit adjoining work, refinish cut surfaces, and repair damaged finish at cuts.
- B. Anchor millwork to anchors or blocking built in or directly attached to substrates. Secure with countersunk, concealed fasteners and blind nailing as required for complete installation. Use fine finishing nails or finishing screws for exposed fastening, countersunk and filled flush with millwork and matching final finish if transparent finish is indicated.
- C. Cabinets: Install without distortion so doors and drawers fit openings properly and are accurately aligned. Adjust hardware to center doors and drawers in openings and to provide unencumbered operation. Complete installation of hardware and accessory items as indicated.
  - Install cabinets with no more than 1/8 inch in 96-inch (3 mm in 2400-mm) sag, bow, or other variation from a straight line.
- D. Countertops: Anchor securely by screwing through corner blocks of base cabinets or other supports into underside of countertop.
  - Align adjacent solid-surfacing-material countertops and form seams to comply with manufacturer's written recommendations using adhesive in color to match countertop. Carefully dress joints smooth, remove surface scratches, and clean entire surface.
  - Install countertops with no more than 1/8 inch in 96-inch (3 mm in 2400-mm) sag, bow, or other variation from a straight line.
  - Secure covered backsplashes to tops and to walls with adhesive per manufacturer's fabrication manual.
  - Caulk space between backsplash and wall with sealant specified in Division 7 Section "Joint Sealants."

### END OF SECTION 06402

### SECTION 06440 - PLASTIC PANELING

- 1.1 SUMMARY
- A. Section Includes the following:
  - Glass-fiber reinforced plastic (FRP) wall paneling.
  - Molding, adhesives, and joint sealants.
- 1.2 PLASTIC SHEET PANELING
- A. General:
  - Low-Emitting Materials: Paneling shall comply with the testing and product requirements of the California Department of Health Services' "Standard Practice for the Testing of Volatile Organic Emissions from Various Sources Using Small-Scale Environmental Chambers."
  - Nominal Thickness: Not less than 0.09 inches.
  - Color: White.
  - Surface Finish: Molded pebble texture.
- 1.3 ADHESIVES
- A. As recommended by plastic paneling manufacturer.
  - VOC Limit: 50 g/L.
- 1.4 ACCESSORIES
- A. Trim Accessories: Manufacturer's standard one-piece vinyl extrusions designed to retain and cover edges of panels. Provide division bars, inside corners, outside corners, and caps as needed to conceal edges.
  - Color: White.
- 1.5 INSTALLATION
- A. Comply with manufacturer's printed instructions, with panel edges plumb and joints flush.
- B. Apply trim accessories at all panel edges.
- END OF SECTION 06440



Starbucks Coffee Company

2401 UTAH AVENUE SOUTH  
SEATTLE, WASHINGTON 98134  
(206) 318-1575

THESE PLANS AND SPECIFICATIONS, AS WELL AS STARBUCKS' NAME, LOGO, TRADEMARKS, AND DESIGNS ARE THE EXCLUSIVE PROPERTY OF STARBUCKS CORPORATION. ANY REPRODUCTION, MODIFICATION, DISCLOSURE, AND/OR USE OF THESE MATERIALS OR ANY PORTION OF THEM WITHOUT STARBUCKS' PRIOR WRITTEN CONSENT IS STRICTLY PROHIBITED.

Architect of Record



I HEREBY CERTIFY THAT THE PORTIONS OF THIS TECHNICAL SUBMISSION BEARING MY SEAL AND SIGNATURE WERE PREPARED BY ME OR UNDER MY SUPERVISION AND RESPONSIBLE CHARGE. I AM A DULY REGISTERED ARCHITECT UNDER THE LAWS OF THE STATE OF TEXAS.

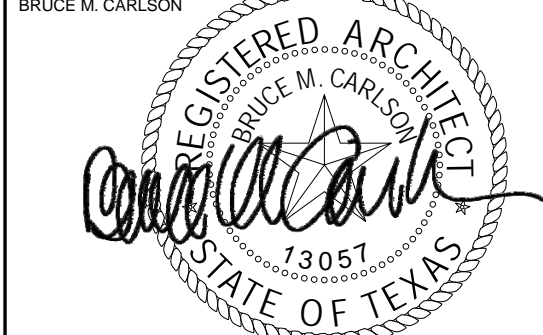

## PERMIT SET

SIGNATURE	BRUCE M. CARLSON		
DATE ISSUED	12/23/11		
REG. NO.	13057		
ISSUE SCHEDULE			
12-23-11	PERMIT SET		
12-23-11	BID SET		
REVISION SCHEDULE			
REV/	DATE	BY	DESCRIPTION

PROJECT NAME:  
**RAYZOR RANCH**

PROJECT ADDRESS:  
2320 W. UNIVERSITY  
DENTON, TX 76201

COUNTY:  
DENTON

STORE #: 16766  
CPN/PROJECT #: 54761-001  
CMA PROJECT #: 11108.034  
CONCEPT: HERITAGE  
DESIGN MANAGER: CAROL KAMENISH  
CONSTRUCTION MANAGER: KATHY TRAVIS

SHEET TITLE:  
**DESIGN SPECIFICATIONS**

SHEET NUMBER:  
**G-003**

ISSUE DATE: 12/23/11

Thermal and Moisture Protection

SECTION 07841 - THROUGH-PENETRATION FIRESTOP SYSTEMS
1.1 SUMMARY
A. This Section includes through-penetration firestop systems for penetrations through fire-resistance-rated constructions, including both empty openings and openings containing penetrating items.
1.2 PERFORMANCE REQUIREMENTS
A. Provide through-penetration firestop systems with the following ratings determined per ASTM E 814 or UL 1479:
1. F-Rated Systems: F-ratings equaling or exceeding fire-resistance rating of constructions penetrated.
2. T-Rated Systems: For penetrations located outside wall cavities and outside fire-resistance-rated shaft enclosures.
3. L-Rated Systems: Where through-penetration firestop systems are indicated in smoke barriers.
1.3 SUBMITTALS
A. Product Data: For each type of product indicated.
1.4 QUALITY ASSURANCE
A. Installer Qualifications: A firm approved by Factory Mutual Global according to FMG 4991, "Approval of Firestop Contractors."
B. Fire-Test-Response Characteristics: Tested per ASTM E 814 by Underwriters Laboratories or OPL.
1.5 MANUFACTURERS
A. VOC Content of Interior Sealants: Provide interior sealants and sealant primers that comply with the following maximum limits for VOC content when calculated according to 40 CFR 59, Subpart D (EPA Method 24):
1. Sealants: 250 g/L.
2. Sealant Primers for Nonporous Substrates: 250 g/L.
3. Sealant Primers for Porous Substrates: 775 g/L.
B. Products: Subject to compliance with requirements, provide systems designed for each specific application.
1.6 MATERIALS
A. Accessories: Provide permanent forming/damming/backing materials, and collars and sleeves as needed to comply with performance requirements. Provide temporary forming materials as required.
B. Identification: Provide materials with preprinted metal or plastic labels, permanently attached.
1.7 FIELD QUALITY CONTROL
A. Inspection of Installed Firestop Systems shall be performed by Owner-engaged agency and shall be conducted according to ASTM E 2174 requirements.
1.8 THROUGH-PENETRATION FIRESTOP SYSTEM SCHEDULE
A. Intumescent Putty for the Following Applications:
1. Metallic Pipes, Conduit, or Tubing.
2. Nonmetallic Pipe, Conduit, or Tubing.
3. Insulated Pipes.
4. Miscellaneous Electrical Penetrations.
B. Latex Sealant for the Following Applications:
1. Miscellaneous Mechanical Penetrations.
2. Groupings of Penetrants.

END OF SECTION 07841

SECTION 07842 - FIRE-RESISTIVE JOINT SYSTEMS
1.1 SUMMARY
A. Fire-resistive joint systems for the following:
1. Floor-to-wall joints.
2. Head-of-wall joints.
3. Wall-to-wall joints.
1.2 PERFORMANCE REQUIREMENTS
A. Fire-Resistance Ratings of Joint Systems in and between Fire-Resistance-Rated Constructions: Equal or exceed the fire-resistance ratings of the construction joined.
B. Provide systems with movement capabilities as determined by UL 2079.
1.3 SUBMITTALS
A. Product Data: Provide data for each type of product indicated.
1.4 QUALITY ASSURANCE
A. Fire-Test-Response Characteristics: Systems shall be tested by Underwriters Laboratories or OPL.
1.5 MATERIALS
A. Products: Subject to compliance with requirements, provide one of the fire-resistive joint systems indicated for each application in the Fire-Resistive Joint System Schedule.
B. Accessories: Provide forming materials and other components needed to install fill materials. Designation System for Joints in or between Fire-Resistance-Rated Constructions: Alphanumeric systems listed in UL's "Fire Resistance Directory" under Product Category XHBN.
D. Floor-to-Wall:
1. UL-Classified Systems: FW-S-0000-0999.
2. Assembly Rating and Nominal Joint Width: As Indicated.
E. Head-of-Wall:
1. UL-Classified Systems: HW-D-0000-0999.
2. Assembly Rating and Nominal Joint Width: As indicated.
3. Movement Capabilities: Class III - compression or extension.
F. Wall-to-Wall:
1. UL-Classified Systems: WW-S-0000-0999.
2. Assembly Rating and Nominal Joint Width: As indicated.

END OF SECTION 07842

Thermal and Moisture Protection (Continued)

SECTION 07920 - JOINT SEALANTS
1.1 SUMMARY
A. This section includes sealants for:
1. Exterior perimeter joints between wall and frames of doors and windows.
2. Interior perimeter joints between wall and frames of doors and windows.
3. Interior joints between plumbing fixtures and adjoining walls, floors, and counters.
4. HVAC joints.
5. Non-porous material to non-porous material joints.
1.2 MATERIALS
A. VOC Content of Interior Sealants: Provide interior sealants and sealant primers that comply with the following limits for VOC content when calculated according to 40 CFR 59, Subpart D (EPA Method 24):
1. Sealants: 250 g/L.
2. Sealant Primers for Nonporous Substrates: 250 g/L.
3. Sealant Primers for Porous Substrates: 775 g/L.
B. Elastomeric Joint Sealants: Liquid applied, chemically curing. ASTM C 920.
1. Suitability for Contact with Food: Where elastomeric sealants are indicated for joints that will come in repeated contact with food, provide products that comply with 21 CFR 177.2600.
2. Multi-component Non-sag Neutral-Curing Silicone Sealant ES-1.
3. Single-Component Mildew-Resistant Neutral-Curing Silicone Sealant ES-2.
4. Single-Component Mildew-Resistant Acid-Curing Silicone Sealant ES-3.
5. Single-Component Mildew-Resistant Acid-Curing RTV Silicone Sealant ES-4.
C. Joint-Sealant Backing:
1. Plastic Foam Joint Fillers: Closed-cell polyethylene foam, preformed, compressible, resilient, and nonabsorbent, of size, shape, and density to provide optimum sealant performance.
1.3 JOINT-SEALANT SCHEDULE
A. Joint-Sealant Application JS-1: Exterior perimeter joints between wall and frames of doors and windows.
1. Joint Sealant: ES-1.
B. Joint-Sealant Application JS-2: HVAC joints.
1. Joint Sealant: ES-2.
2. Joint-Sealant Color: Aluminum.
C. Joint-Sealant Application JS-3: Interior joints between plumbing fixtures and adjoining walls, floors, and counters.
1. Joint Sealant: ES-3.
2. Joint-Sealant Color: White.
D. Joint-Sealant Application JS-4: Non-porous material to non-porous material.
1. Joint Sealant: ES-4.
2. Joint-Sealant Color: Clear.
E. Joint-Sealant Application JS-5: Perimeter joints between interior wall surfaces and frames of interior doors, windows.
1. Joint Sealant: ES-3.
1.4 INSTALLATION
A. Comply with sealant material manufacturer's printed instructions for preparation of surfaces and installation of sealants.
B. Install joint sealants to have straight edges, flush with adjacent surfaces.
C. Clean sealant off of adjacent surfaces.

END OF SECTION 07920

Doors and Windows

SECTION 08211 - FLUSH WOOD DOORS
1.1 SUMMARY
A. Furnish and install new wood doors as scheduled on the drawings.
1.2 SUBMITTALS
A. Product Data: Submit product data for each type of door indicated. Include details of core and edge construction and trim for openings.
B. Shop Drawings: Indicate location, size, and hand of each door; elevation of each kind of door; construction details not covered in Product Data, location and extent of hardware blocking; and other pertinent data.
1. Indicate dimensions and locations of mortises and holes for hardware.
2. Indicate dimensions and locations of cutouts.
3. Indicate doors to be factory finished and finish requirements.
C. Warranty: Sample of special warranty.
1.3 QUALITY ASSURANCE
A. Quality Standard: AWI.
1. Submit AWI Quality Certification Labels or an AWI letter of licensing for doors.
2. Submit WI-Certified Compliance Certificate for doors and installation.
B. Warranty
1. Repair or replace doors effective in materials or workmanship for the life of the installation.
1.4 DOOR CONSTRUCTION GENERAL
A. Low-Emitting Materials: Made with adhesives and composite wood products that do not contain urea formaldehyde.
1.5 PRIMING/FINISHING
A. Shop Priming:
1. Doors for Opaque Finish: One coat of wood primer.
1.6 VENEERED-FACED DOORS FOR OPAQUE FINISH
A. Interior Solid-Core Doors:
1. Grade: Premium, with Grade A faces.
2. Core: Particleboard.
3. Construction: Five or seven plies, bonded.

END OF SECTION 08211

SECTION 08900 - GLAZING
1.1 SUMMARY
A. Glazing required for the following:
1. Storefront framing.
1.2 SUBMITTALS
A. Product Data: For each glass product and glazing material indicated.
B. Glazing Schedule: Use same designations indicated on Drawings for glazing openings in preparing a schedule listing glass types and thicknesses for each size opening and location.
C. Product Certificates: Signed by manufacturers of glass and glazing products certifying that products furnished comply with requirements.
1. For solar-control low-e-coated glass, provide documentation demonstrating that manufacturer of coated glass is certified by coating manufacturer.
D. Warranties: Special warranties specified in this Section.
1.3 WARRANTY
A. Deterioration of Coated Glass: Not less than 10 years.
B. Deterioration of Insulating Glass: Not less than 10 years.
1.4 MATERIALS
A. Glass Products:
1. Insulating Glass: Manufacturer's standard dual-seal units.
B. Silicone Glazing Sealants: Neutral curing, Class 25 VOC less than 250 g/L.
C. Glazing Tapes and Gaskets: As recommended by the glass manufacturer for each application.
1.5 INSULATING-GLASS UNITS
A. Solar-Control Low-E Insulating-Glass Units IG-1:
1. Appearance: Match existing glass.
2. Overall Unit Thickness: 1".
3. Interspace Content: Air.
4. Outdoor Lite: Class 1 float glass, 1/4" thick.
5. Indoor Lite: Class 1 float glass, 1/4" thick.
6. Low-E Coating: Sputtered on second or third surface.
7. Visible Light Transmittance: 70 percent minimum.
8. Winter Nighttime U-Factor: 0.35 maximum.
9. Summer Daytime U-Factor: 0.35 maximum.
10. Solar Heat Gain Coefficient: .62 maximum.
11. Outdoor Visible Reflectance: 17 percent maximum.

END OF SECTION 08900

Finishes

SECTION 09111 - NON-LOAD-BEARING STEEL FRAMING
1.1 SUMMARY
A. Non-load-bearing steel framing members for interior framing systems.
1.2 MATERIALS
A. Steel Framing for Framed Assemblies:
B. Framing Members, General: Comply with ASTM C 754 for conditions indicated.
1. Steel Sheet Components: Comply with ASTM C 645 requirements for metal.
2. Protective Coating: Coating with equivalent corrosion resistance of ASTM A 653/A 653M, G40 (Z20), hot-dip galvanized.
1.3 STEEL FRAMING FOR FRAMED ASSEMBLIES
A. Salvaged Material: Use salvaged framing materials whenever available.
B. Steel Studs and Runners:
1. Minimum Base-Metal Thickness: 0.0312 inch (0.79 mm).
2. Depth: As indicated on Drawings.
C. Slip-Type Headed Joints: Where indicated, provide one of the following:
1. Single Long-Leg Runner System: Top runner with 2-inch (50.8-mm) deep flanges in thickness not less than indicated for studs, installed with studs friction fit into top runner and with continuous bridging located within 12 inches (305 mm) of the top of studs to provide lateral bracing.
2. Double-Runner System: Top runners, inside runner with 2-inch (50.8-mm) deep flanges in thickness not less than indicated for studs and fastened to studs, and outer runner sized to friction fit inside runner.
D. Cold-Rolled Channel Bridging: 0.0538-inch (1.37-mm) bare-steel thickness, with minimum 1/2-inch (12.7-mm) wide flanges.
1. Depth: 1-1/2 inches (38.1 mm).
2. Clip Angle: Not less than 1-1/2 by 1-1/2 inches (38.1 by 38.1 mm), 0.068-inch (1.73-mm) thick, galvanized steel.
E. Hat-Shaped, Rigid Furring Channels:
1. Minimum Base Metal Thickness: 0.0312 inch (0.79 mm).
2. Depth: As indicated on Drawings.
F. Cold-Rolled Furring Channels: 0.0538-inch (1.37-mm) bare-steel thickness, with minimum 1/2-inch (12.7-mm) wide flanges.
1. Depth: As indicated on Drawings.
2. Furring Brackets: Adjustable, corrugated-edge type of steel sheet with minimum bare-steel thickness of 0.0312 inch (0.79 mm).
3. Tie Wire: ASTM A 641/A 641M, Class 1 zinc coating, soft temper, 0.0625-inch (1.59-mm) diameter wire, or double strand of 0.0475-inch (1.21-mm) diameter wire.
G. Z-Shaped Furring: With slotted or non-slotted web, face flange of 1-1/4 inches (31.8 mm), wall attachment flange of 7/8 inch (22.2 mm), minimum bare-metal thickness of 0.0179 inch (0.45 mm), and depth required to fit insulation thickness indicated.

END OF SECTION 09111

SECTION 09260 - GYPSUM BOARD
1.1 SUMMARY
A. Interior gypsum board.
1.2 SUBMITTALS
A. Product Data: For each type of product indicated.
B. Samples: For the following products:
1. Textured Finishes: Manufacturer's standard size for each textured finish indicated and on same backing indicated for work.
1.3 MATERIALS
A. General Requirements:
1. Complying with ASTM C 1396/C 1396M, as applicable to type of gypsum board indicated. Must be certified as low emitting. Certification must be based upon the California Department of Health Services Standard Practice for the Testing of Volatile Organic Emissions from Various Sources Using Small-Scale Environmental Chambers, including 2004 Addenda or a jurisdictionally recognized standard using equivalent testing methodologies and VOC thresholds.
3. Fire resistance rating: Type X.
B. Interior Gypsum Board:
1. Moisture- and mold-resistant type: With moisture- and mold-resistant core and surfaces.
2. Edges: Long edges tapered.
C. Tile-Backing Panels: Water-resistant gypsum backing board.
1. Manufacturers: Subject to compliance with requirements, provide products by one of the following:
a. CertainTeed "GlasRoc."
b. Georgia-Pacific "DensShield."
c. Temple-Inland "GreenGlass."
d. U. S. Gypsum "Fiberock."
D. Trim Accessories:
1. Interior: Provide metal cornerbead at all outside corners.

END OF SECTION 09260

SECTION 09510 - ACOUSTICAL PANEL CEILINGS
1.1 SUMMARY
A. Acoustical panels and exposed suspension systems.
1.2 SUBMITTALS
A. Product Data: Submit data for each type of product indicated.
B. Coordination Drawings: Provide reflected ceiling plans, drawn to scale, on which the following items are shown and coordinated with each other, based on input from installers of the items involved:
1. Ceiling suspension system members.
2. Method of attaching hangers to building structure.
3. Ceiling-mounted items including lighting fixtures, diffusers, grilles, speakers, sprinklers, access panels, and special moldings.
C. Samples for Verification: Provide sample for each component and for each exposed finish.
1. Acoustical Panel: Set of full-size Samples of each type, color, pattern, and texture.
2. Exposed Suspension System Members, Moldings, and Trim: Set of 12-inch (300-mm) long samples of each type, finish, and color.
D. Maintenance Data: For finishes to include in maintenance manuals.
1.3 QUALITY ASSURANCE
A. Acoustical Panel Quality Standard: ASTM E 1264.
B. Metal Suspension System Quality Standard: ASTM C 635.
C. Acoustical Ceiling Panels: Must be certified as low emitting. Certification must be based upon the California Department of Health Services Standard Practice for the Testing of Volatile Organic Emissions from Various Sources Using Small-Scale Environmental Chambers, including 2004 Addenda or a jurisdictionally recognized standard using equivalent testing methodologies and VOC thresholds.
1.4 MATERIALS
A. As scheduled on the drawings.
1.5 INSTALLATION
A. Installation: Comply with ASTM C 636.
1.6 FIELD QUALITY CONTROL
A. Testing: By Owner- engaged agency to test acoustical panel ceiling hanger fasteners.

END OF SECTION 09510

SECTION 09720 - WALL COVERINGS
1.1 SUMMARY
A. Vinyl and woven glass-fiber wall covering.
1.2 MATERIALS
A. General: Install Starbucks Coffee Company supplied wall covering.
1. Must be certified as low emitting. Certification must be based upon the California Department of Health Services Standard Practice for the Testing of Volatile Organic Emissions from Various Sources Using Small-Scale Environmental Chambers, including 2004 Addenda or a jurisdictionally recognized standard using equivalent testing methodologies and VOC thresholds.
B. Adhesive: Mildew-resistant, non-staining, strippable adhesive, for use with specific wall covering and substrate application, as recommended in writing by wall-covering manufacturer, and with a VOC content of 50 g/L or less when calculated according to 40 CFR 59, Subpart D (EPA Method 24).
1.3 INSTALLATION
A. Install strips in same order as cut from roll.

END OF SECTION 09720

Finishes (Continued)

SECTION 09910 - INTERIOR PAINTING
1.1 SUMMARY
A. Surface preparation and the application of paint systems on interior substrates.
1.2 SUBMITTALS
A. Samples for Verification:
1. Submit samples for each type of paint system and in each color and gloss of topcoat indicated.
1.3 QUALITY ASSURANCE
A. Quality Standards: "MPI Approved Products List" and "MPI Architectural Painting Specification Manual."
1.4 MANUFACTURERS
A. Manufacturers: Subject to compliance with requirements, provide products manufactured by the Sherwin-Williams Company, or approved equal.
1.5 GENERAL
A. Chemical Components of Field-Applied Interior Paints and Coatings:
1. Maximum VOC Content Limits:
a. Flat Paints and Coatings: 50 g/L.
b. Non-flat Paints and Coatings: 150 g/L.
c. Primers, Sealers, and Undercoaters: 200 g/L.
d. Anticorrosive Coatings: 250 g/L.
1.6 PRIMERS/SEALERS
A. Primer Sealer, Interior, Institutional Low Odor/VOC: MPI #149.
1. Sherwin-Williams Company; Harmony Interior Latex Primer, or approved equal
B. Wood-Knot Sealer: Sealer recommended in writing by topcoat manufacturer for use in paint systems indicated.
1.7 METAL PRIMERS
A. Rust-Inhibitive Primer (Water Based): MPI #107.
1.8 LATEX PAINTS
A. Latex, Interior, Institutional Low Odor/VOC, (Gloss Level 2): MPI #144.
1. Sherwin-Williams Company; Harmony Interior Latex, or approved equal
B. Latex, Interior, High Performance Architectural, Semi-Gloss (Gloss Level 5): MPI #141.
1.9 INTERIOR PAINTING SCHEDULE
A. Steel Substrates:
1. Institutional Low-Odor/VOC Latex System: MPI INT 5.1S.
a. Prime Coat: Institutional low-odor/VOC interior latex matching topcoat.
b. Intermediate Coat: Institutional low-odor/VOC interior latex matching topcoat.
c. Topcoat: Institutional low-odor/VOC interior latex (eggshell).
B. Gypsum Board Substrates:
1. Institutional Low-Odor/VOC Latex System: MPI INT 9.2M.
a. Prime Coat: Interior latex primer/sealer.
b. Intermediate Coat: Institutional low-odor/VOC interior latex matching topcoat.
c. Topcoat: Institutional low-odor/VOC interior latex (eggshell).

END OF SECTION 09910

SECTION 09920 - EXTERIOR PAINTING
1.1 SUMMARY
A. Surface preparation and the application of paint systems on exterior substrates.
1.2 SUBMITTALS
A. Samples for Verification:
1. Submit samples for each type of paint system and in each color and gloss of topcoat indicated.
1.3 QUALITY ASSURANCE
A. Quality Standards: "MPI Approved Products List" and "MPI Architectural Painting Specification Manual."
1.4 METAL PRIMERS
A. Acrylic Metal.
1.5 WOOD PRIMERS
A. Exterior Latex Wood Primer: MPI #6.
B. Exterior Oil Wood Primer: MPI #7.
EXTERIOR LATEX PAINTS
A. Exterior Latex (Satin): MPI #15 (Gloss Level 4).
B. Exterior Latex (Semi-gloss): MPI #11 (Gloss Level 5).
1.6 QUICK-DRYING ENAMELS
A. Quick-Drying Enamel (Semi-gloss): MPI #81 (Gloss Level 5).
1.7 EXTERIOR PAINTING SCHEDULE
A. Steel Substrates:
1. Quick-Drying Enamel System: MPI EXT 5.1A.
B. Galvanized-Metal Substrates:
1. Latex System: MPI EXT 5.3A.
C. Factory Primed Metal Substrates:
1. Latex System: MPI EXT 5.4H.
D. Wood - New, Unfinished, Siding and Trim:
1. Latex System: MPI EXT 6.1L.
E. Wood - Existing, Painted.
1. Latex System: MPI EXT 6.3L.
F. Stucco Substrates:
1. Latex System: MPI EXT 9.1A.

END OF SECTION 09920

SECTION 09931 - WOOD STAINS AND TRANSPARENT FINISHES
1.1 SUMMARY
A. Surface preparation and application of wood finishes on exterior and interior substrates.
1.2 SUBMITTALS
A. Samples for Verification: Submit samples for each type of finish system and in each color and gloss of finish indicated.
1.3 QUALITY ASSURANCE
A. Quality Standards: "MPI Approved Products List" and "MPI Architectural Painting Specification Manual."
1.4 GENERAL
A. Chemical Components of Field-Applied Interior Paints and Coatings:
1. VOC Limits:
a. Clear Wood Finishes, Varnishes: VOC not more than 350 g/L.
b. Shellacs, Clear: VOC not more than 730 g/L.
c. Stains: VOC not more than 250 g/L.
d. Primers, Sealers, and Undercoaters: 200 g/L.
1.5 PRIMERS AND SEALERS
A. Exterior Oil Wood Primer: MPI #7.
1.6 STAINS
A. Exterior Semitransparent Latex Stain: MPI #13.
B. Exterior, Solid-Color Latex Stain: MPI #16.
C. Stain, Semi-Transparent, for Interior Wood: MPI #90.
1.7 VARNISHES
A. Interior Varnish (Semi-gloss): MPI #74.
B. Interior Varnish (Gloss): MPI #75, Gloss Level 6, alkyd type.
1.8 EXTERIOR WOOD-FINISH-SYSTEM SCHEDULE
A. Solid-Color Latex Stain System: MPI EXT 6.3K.
1. Prime Coat if Tannin Bleeding occurs: Exterior oil wood primer.
2. Two Stain Coats: Exterior, solid-color latex stain.
B. Semitransparent Stain System: MPI EXT 6.3D.
1. Two Stain Coats: Exterior semitransparent latex stain.
1.9 INTERIOR WOOD-FINISH-SYSTEM SCHEDULE
A. Semitransparent Stain System: MPI INT 6.3C.
1. Prime Coat: Stain, semi-transparent, matching topcoat.
2. Topcoat: Stain, semi-transparent, for interior wood.
B. Polyurethane Varnish System: MPI INT 6.3K.
1. Two Field-Applied Finish Coats: Interior Varnish satin.

END OF SECTION 09931



Starbucks Coffee Company

2401 UTAH AVENUE SOUTH SEATTLE, WASHINGTON 98134 (206) 318-1575

THESE PLANS AND SPECIFICATIONS, AS WELL AS STARBUCKS' NAME, LOGO, TRADEMARKS, AND DESIGNS ARE THE EXCLUSIVE PROPERTY OF STARBUCKS CORPORATION. ANY REPRODUCTION, MODIFICATION, DISCLOSURE, AND/OR USE OF THESE MATERIALS FOR ANY PORTION OF THEM WITHOUT STARBUCKS' PRIOR WRITTEN CONSENT IS STRICTLY PROHIBITED.

Architect of Record



I HEREBY CERTIFY THAT THE PORTIONS OF THIS TECHNICAL SUBMISSION BEARING MY SEAL AND SIGNATURE WERE PREPARED BY ME OR UNDER MY SUPERVISION AND RESPONSIBLE CHARGE. I AM A FULLY REGISTERED ARCHITECT UNDER THE LAWS OF THE STATE OF TEXAS. BRUCE M. CARLSON



PERMIT SET

SIGNATURE: BRUCE M. CARLSON
DATE ISSUED: 12/23/11
REG. NO.: 13067

Table with 2 columns: Issue Schedule (12-23-11 PERMIT SET, 12-23-11 BID SET) and Revision Schedule (REVI, DATE, BY, DESCRIPTION)

PROJECT NAME: RAYZOR RANCH
PROJECT ADDRESS: 2320 W. UNIVERSITY DENTON, TX 76201
COUNTY: DENTON

STORE #: 16766
CPN/PROJECT #: 54761-001
CMA PROJECT #: 11108.034
CONCEPT: HERITAGE
DESIGN MANAGER: CAROL KAMENISH
CONSTRUCTION MANAGER: KATHY TRAVIS

DESIGN SPECIFICATIONS

SHEET NUMBER: G-004

ISSUE DATE: 12/23/11

Address 54761-001  
 Store Name Rayzor Ranch  
 Store Number 16766  
 Project Type NEWJU  
 2320 University Drive  
 Address Denton, TX 76207  
 United States

Alternate Address

Category	Mapping Status	Design ID	Revit Description	Qty	Unit of Meas	Item Number	Item Description	Item Status	Responsibility	Stocking Status	Manufacturer	Model #	Bulb	Volts	Watts	Amps	Old Tag	Comments	
Casework	1 - Success	11155	Espresso Machine Pump Mount - 10x10in	2	Ea	011012954	MOUNT MACHINE PUMP 10X10"	A	VD	PBI		11155 MACHINE PUMP MOUNT 10X10IN					N114, V401		
Casework	1 - Success	11894	Scale Toe Kick - 40in	1	Ea	011012993	TOE KICK SCALE CORNER 12"	A	VD	PBI		11894 SCALE TOE KICK CORNER 12IN					N126		
Casework	1 - Success	11899	Cabinet - Scale Cubby - 12in	1	Ea	011013047	CUBBY SCALE 12"	A	VD	PBI		11899 SCALE CUBBY 12IN					N010		
Casework	1 - Success	11895	Cabinet - Scale for Safe - LH - 26in	1	Ea	011013090	CABINET SCALE SAFE LH 26"	A	VD	PBI		11895 SCALE FOR SAFE LH 26IN					N061		
Casework	1 - Success	11902	Cabinet - Upper Cubby - 28x16x15in 700x405x375mm	1	Ea	011013182	CUBBY UPPER 27X16X14"	A	VD	PBI		11902 UPPER CUBBY 27X16X14IN					N084		
Casework	1 - Success	11903	Cabinet - Cubby Tall - 32x16x94in	1	Ea	011013144	CUBBY TALL 32X16X94"	A	VD	PBI		11903 CUBBY TALL 32X16X94IN					N139		
Casework	1 - Success	11915	Countertop - Work Sink Stainless - 15in	1	Ea	011013273	COUNTERTOP SS SINK 15"	A	VD	PBI		11915 15IN STAINLESS SINK					N218		
Casework	1 - Success	11916	POS Toe Kick Corner - 9in 2415mm	1	Ea	011013286	TOE KICK POS 9"	A	VD	PBI		11916 POS TOE KICK 9IN					N122		
Casework	1 - Success	11925	Countertop - Handoff Rounded Solid Surface - LH - 30x33in	1	Ea	011013371	SOLID SURF HANDOFF LH 30X33"	A	VD	PBI		11925 HANDOFF ROUNDED SOLID SURFACE LH 30X33IN						N144	
Casework	1 - Success	11944	Countertop - DT POS Solid Surface - RH - Variable to 92in	2	Ea	011013525	SOLID SURF DT POS RH VAR. 92"	A	VD	PBI		11944 DT POS SOLID SURFACE RH VARIABLE TO 92IN						N227	
Casework	1 - Success	11945	Cabinet - 12in	9	Ea	011013536	CABINET 12" W/ DOOR	A	VD	PBI		11945 12IN WTH DOOR						N008	
Casework	1 - Success	11951	Panel - POS - 32.5in 825mm	2	Ea	011013573	PANEL POS 32.5"	A	VD	PBI		11951 POS 32.5IN						N105	
Casework	1 - Success	11957	Panel - Cup Dispenser	1	Ea	011013628	DISPENSER CUP"	A	VD	PBI		11957 CUP DISPENSER						N112	
Casework	1 - Success	11966	Cabinet - DT POS Cubby - 26x15x30in	1	Ea	011013688	CUBBY DT POS 26X15X30IN	A	VD	PBI		11966 DT POS CUBBY 26X15X30IN						N035	
Casework	1 - Success	11971	Cabinet - Sink or Ice Bin - 15in	2	Ea	011013748	CABINET DOOR 15IN	A	VD	PBI		11971 15IN DOOR						N010	
Casework	1 - Success	11972	Cabinet - Espresso with Cup Dispenser - 24in	1	Ea	011013759	CABINET ESP W/CUP DISPENSER 24"	A	VD	PBI		11972 ESPRESSO WITH CUP DISPENSER 24IN						N024	
Casework	1 - Success	11977	Cabinet - Upper Cubby - 24x16x21in 610x405x535mm	10	Ea	011013801	CUBBY UPPER 24X16X21"	A	VD	PBI		11977 UPPER CUBBY 24X16X21IN						N083	
Casework	1 - Success	11978	Countertop - CBS Shared Rinse Sink and Ice Bin L Shape Solid Surface - RH - 84x67in	1	Ea	011013812	SOLID SRF SINK/ICE L RH 84X67"	A	VD	PBI		CBS SINK AND ICE BIN L SHAPE COMPOSITE RH 84X67IN						N216	
Casework	1 - Success	11990	Cabinet - POS with Filler - LH - 29in 735mm	1	Ea	011013838	CABINET POS W/FILLER LH 29"	A	VD	PBI		11990 POS WITH FILLER LH 29IN						N055	
Casework	1 - Success	11994	POS Double Server Shroud - 30in 760mm	1	Ea	011013991	SHROUD POS BREWER 30"	A	VD	PBI		11994 POS BREWER SHROUD 30IN						N118	
Casework	1 - Success	12007	Cabinet - Sink - 24in	1	Ea	011014093	CABINET SINK 24"	A	VD	PBI		12007 SINK 24IN						N031	
Casework	1 - Success	12018	Countertop - Scale Solid Surface - LH - 40in	1	Ea	011014184	SOLID SURF SCALE LH 40"	A	VD	PBI		12018 SCALE SOLID SURFACE LH 40IN						N193	
Casework	1 - Success	12026	Panel - Scale - LH - 40in	1	Ea	011014232	PANEL SCALE LH 40"	A	VD	PBI		12026 SCALE LH 40IN						N084	
Casework	1 - Success	12029	Condiment Cart Base - 40in	1	Ea	011014242	BASE CAFÉ CONDIMENT CART 40"	A	VD	PBI		12029 CONDIMENT CART BASE 40IN						N043	
Casework	1 - Success	12033	DT Counter Support Panel - 6in	1	Ea	011014268	PANEL DT COUNTER SUPPORT 6"	A	VD	PBI		12033 DT COUNTER SUPPORT PANEL 6IN						N050	
Casework	1 - Success	12043	Cabinet - POS - 29in	1	Ea	011014345	CABINET POS 29IN	A	VD	PBI		12043 POS 29IN						N057	
Casework	1 - Success	12048	Cabinet - CBS Ice Bin - RH - 24in	1	Ea	011014365	CABINET CBS ICE BIN RH 24IN	A	VD	PBI		12048 CBS ICE BIN RH 24IN						N026	
Casework	1 - Success	12066	Cabinet - Espresso Inline Narrow - 24x8.5in	1	Ea	011014193	CABINET ESP NRRWNL 24X8.5"	A	VD	PBI		12066 ESPRESSO NARROW INLINE 24X8.5IN						N029	
Casework	1 - Success	12069	Cabinet - Brew Grind with Pullout Shelf - LH - 33in	1	Ea	011014160	CABINET BREW GRND W/SHLF LH 33"	A	VD	PBI		12069 BREW GRIND WITH PULLOUT SHELF LH 33IN						N041	
Casework	1 - Success	12070	Diewall - Inline Handoff Support - LH	1	Ea	011014147	DIEWALL HANDOFF SUPPORT INL LH	A	VD	PBI		12070 HANDOFF SUPPORT INLINE LH						N052	
Casework	1 - Success	12073	Fit Kit - Backbar Side Splash	2	Ea	011014120	BACK SPLASH BACKBAR	A	VD	PBI		12073 BACKBAR BACK SPLASH						N113	
Casework	1 - Success	12088	Cabinet - POS with Filler - RH - 29in 735mm	1	Ea	011014011	CABINET POS W/FILLER RH 29"	A	VD	PBI		12088 POS WITH FILLER RH 29IN						N059	
Casework	1 - Success	12096	Cabinet - with Drawer - 15in	1	Ea	011013939	CABINET 15" DRAWER & DOOR	A	VD	PBI		12096 15IN DRAWER AND DOOR						N013	
Casework	1 - Success	12100	Espresso Countertop Support Leg Stainless	3	Ea	011013805	SUPPORT LEG ESP COUNTERTOP	A	VD	PBI		12100 ESPRESSO COUNTERTOP SUPPORT LEG SST						N142	
Casework	1 - Success	12109	Wall Unit Solid Back	4	Ea	011013864	WALL UNIT SOLID BACK 32X94"	A	VD	PBI		12109 WALL UNIT SOLID BACK 32X16X94IN						N140	
Casework	1 - Success	12126	Condiment Cart Top Solid Surface - 40in	1	Ea	011013745	SOLID SURF TOP COND CART 40"	A	VD	PBI		12126 CONDIMENT CART TOP SOLID SURFACE 40IN						N186	
Casework	1 - Success	12127	Cabinet - POS with Cup Dispenser Panel - 30in 760mm	1	Ea	011013738	CABINET POS W/CUP DISPENSER 30"	A	VD	PBI		12127 POS WITH CUP DISPENSER 30IN						N039	
Casework	1 - Success	12756	Cabinet - 24in	2	Ea	011013363	CABINET 24IN	A	VD	PBI		12756 24IN WITH DOOR						N288	
Casework	1 - Success	12756	Counter - Solid Surface - 24in	2	Ea	011013354	SOLID SURF 24"	A	VD	PBI		12756 24IN SOLID SURFACE						N289	
Casework	1 - Success	12762	Panel - Espresso Inline - LH - 140in	1	Ea	011013305	PANEL FINISH LH 140"	A	VD	PBI		12762 FINISH LH 140IN						N286	
Casework	1 - Success	12763	Espresso Inline Sneeze Guard for 140in	1	Ea	011013286	SNEEZE GUARD 140"	A	VD	PBI		12763 SNEEZE GUARD 140IN						N287	
Casework	1 - Success	12764	Countertop - Espresso Inline Ice Bin and Integral Rinse Sink Stainless - LH - 140in	1	Ea	011013287	COUNTER ESP INLINT SINK LH 140"	A	VD	PBI		12764 ESPRESSO INLINE W/ INTEGRAL SINK SST LH 140IN						N288	
Casework	1 - Success	12765	Diewall - Espresso Inline - LH - 140in	1	Ea	011013278	DIEWALL ESP LH 140"	A	VD	PBI		12765 ESPRESSO LH 140IN						N289	
Casework	1 - Success	12766	Diewall - Espresso Inline Top Cap - LH - 140in	1	Ea	011013270	TOP CAP INLINE LH 140"	A	VD	PBI		12766 INLINE LH 140IN						N300	
Casework	1 - Success	12778	Countertop - Brew Grnd Work Sink and Trash Solid Surface LH - 102in	1	Ea	011013190	SOLID SRF BRW SINK/TRSH LH 102"	A	VD	PBI		12778 BREW SOLID SURFACE SINK TRASH LH 102IN						N312	
Casework	1 - Success	12786	Cabinet - Trash Drop - 15in	1	Ea	011013123	CABINET TRASH 15"	A	VD	PBI		12786 15IN TRASH						N320	
Casework	1 - Success	12787	Counter - Solid Surface - 15in	1	Ea	011013115	COUNTER SOLID SURFACE 15"	A	VD	PBI		12787 15IN SOLID SURFACE						N321	
Casework	1 - Success	12816	French Cleat - Variable to 96in 2440mm	5	Ea	011012952	CLEAT FRENCH FOR WALL CUBBIES	A	VD	PBI		12816 FRENCH CLEAT VARIABLE TO 96IN						N341	Designer To Verify Quantity. Provide Overall Length Required
Casework	4 - No Item Number Found	10743	New York Times Newspaper Stand	1	Ea				GC									M006	
Casework	4 - No Item Number Found	12775	Panel - POS Double Server - 30in 760mm	1	Ea				VD									NA	
Casework	4 - No Item Number Found	12845	Soffit - Light Valance - 96x2in 2440x50mm	3	Ea				VD									N342	Designer To Verify Quantity. Provide Overall Length Required
Casework	4 - No Item Number Found	13287	Countertop - POS Double Server Solid Surface - 30in 760mm	1	Ea				VD									NA	
Casework	7 - Custom Item	x0100	CUSTOM UPPER CUBBY	1	Ea				VD									NA	
Casework	7 - Custom Item	x0101	CUSTOM BIN CABINET	1	Ea				VD									NA	
Casework	7 - Custom Item	x0102	CUSTOM COUNTERTOP AT POS	1	Ea				VD									NA	
Casework	7 - Custom Item	x0104	POS CUP DISPENSER PANEL	2	Ea				VD									NA	Similar to 12789
Casework	7 - Custom Item	x0105	VERTICAL STEEL CAP	2	Ea				GC									NA	
Casework	7 - Custom Item	x0108	CUSTOM WOOD TOP CAP	1	Ea				VD									NA	6'-3/8" W/F
Casework	7 - Custom Item	x0110	VERTICAL WOOD CAP	1	Ea				GC									NA	
Casework	7 - Custom Item	x0111	CUSTOM UPPER CUBBY	1	Ea				VD									NA	
Casework	7 - Custom Item	x0112	Soffit - Light Valance - 96x2in 2440x50mm	1	Ea				VD									NA	Designer To Verify Quantity. Provide Overall Length Required
DataDevices	1 - Success	10000	Phone Line	1	Ea	000178081	TELEPHONE 1 LINE WHOLE	A	SB	WH	SCITEC	STANDARD						A001, A003, A040	
DataDevices	1 - Success	10005	Music System	1	Ea	000512896	MUSIC PLAYER C400	IJ	3PL	WH	ANTEX	C400U						A006, A009, A010, A024, A026, A028	
DataDevices	1 - Success	10011	Equipment Rack - 6in	1	Ea	000178662	RACK KIT 6FT APOLLO W/ SHELVES	A	VD	VD		6' APOLLO KIT WITH SHELVES						A022, A032, A034, A035, A100, A150, A200	
DataDevices	1 - Success	10017	Speaker Surface Mounted - (Designer Specify) White or Black	3	Ea	000454505	SPEAKER SURFACE MOUNT W/50 FT W/RE	A	SB	WH		50' W/RE						A006, A044	
DataDevices	1 - Success	10028	POS Bank	9	Ea	000155278	DROP BOX	A	SB	WH	AMERICAN SECURITY PRODUCTS CO	GENERAL LIC 1						A046, A011, A021, A023	
DataDevices	1 - Success	10035	Monitor Stand Wall Mounted	1	Ea	000178757	MONITOR MOUNT DRIVE THRU	A	VD	WH	VIDEO MOUNT PRODUCTS	MONITOR MOUNT DRIVE THRU						M073, M516	
DataDevices	1 - Success	10076	Amplifier	1	Ea	000512789	AMPLIFIER 60W MUSIC SYSTEM	A	3PL	WH	ATLAS	60W PA891	100-240VAC	0.55 AMPS				A037	
DataDevices	2 - Multiple Item Numbers	10024	Safe - LH - 20x18x26in	1	Ea	000248187	SAFE 26X20 SAFEMZARD L-SWING	A	VD										

Address 54761-001  
 Store Name RAYZOR RANCH  
 Store Number 16766  
 Project Type NEWFU  
 2320 University Drive  
 Address Denton, TX 76207  
 United States

Alternate Address

Category	Mapping Status	Design ID	Revit Description	Qty	Unit of Measure	Item Number	Item Description	Item Status	Responsibility	Stocking Status	Manufacturer	Model #	Bulb	Volts	Watts	Amps	Old Tag	Comments
Furniture	1 - Success	11060	Table - Counter Top - 5ft - Natural Maple	2	Ea	001004041	TABLE TOP SIT HERE SAVEUR	A	3PL	WH	JMKNOVN						F085	SC TO CUSTOM CUT (1) TOP TO FIT BRACE IN FIELD AS REQUIRED
Furniture	1 - Success	11113	Table - Top Square - 24in 610mm - Walnut	8	Ea	001006080	TABLE TOP 24IN SQUARE CLASSICO	A	3PL	VD							F101, F637	
Furniture	1 - Success	11625	Chair - Cafe Bistro Suite - Tweed Women F0041	20	Ea	011008610	CHAIR SIDE BISTRO NAT. TWEED	A	3PL	WH	BISTR0						F886, J135, U135, Y135	
Furniture	1 - Success	12142	Chair - Cafe Upholstered - 16in Distressed Walnut and Burgundy	27	Ea	011011985	CHAIR CAFE BENTWOOD UPH. RED	A	3PL	WH	UNICHAIRS INC	12142 BENTWOOD UPHOL					F901, J104, U104, Y104	
Furniture	1 - Success	12163	Table - Community with Metal Braces - Distressed Honey Brown WD0002	1	Ea	011008183	TABLE COMMUNITY WOOD HERITAGE	A	3PL	WH	QUACKENBUSH AND WINKLER	HTCM 002					F910, J364, U364, Y364	
Furniture	1 - Success	12189	Table - Top Square - 24in 610mm - White with Veining CP0002	7	Ea	011007894	TABLE TOP SQUARE CORIAN 24"	A	3PL	WH	CORIAN						F918, J400, Y400, U400	
Furniture	1 - Success	12241	Table - Cafe Steel Strap Base - 36x24in 965x810mm - Amber Honey WD0005	1	Ea	011010190	TABLE ADA W/METAL STRAPS	A	3PL	WH	WEST COAST INDUSTRIES	12241 38X24					F941, J352, U352, Y352	
Furniture	1 - Success	12321	Chair - Barstool 29in Industrial - Hot Rolled Steel and Pressboard	5	Ea	011011002	STOOL 29" W/BACK MASONITE	A	3PL	WH		12321 ST 36GL W/BACK 29" MASONITE					F938, J191, U191, Y191	
Furniture	1 - Success	12679	Education Disk Alternative Transportation Bike	1	Ea	011016929	ED DISK ALTERNATE TRAN BIKE	A		VD							J840, Y840, U840	
Furniture	1 - Success	12680	Education Disk Mugs	1	Ea	011016933	ED DISK MUGS	A		VD							J841, Y841, U841	
Furniture	1 - Success	12686	Education Disk Responsible Materials	1	Ea	011016951	ED DISK RESPONSIBLE MATERIALS	A		VD							J845, Y845, U845	
Furniture	1 - Success	12686	Education Disk Water Rinse on Demand	1	Ea	011016954	ED DISK RINSE ON DEMAND	A		VD							J847, Y847, U847	
Furniture	2 - Multiple Item Numbers	12180	Table - Accessible Metal Suite - 39x23in 990x585mm - Black MT0022	2	Ea	011007751	TABLE OUTDOOR ADA BLACK	A	3PL	WH	WEST COAST INDUSTRIES	ECT.005					F875, J353, U353, Y353	
Furniture	2 - Multiple Item Numbers	12180	Table - Accessible Metal Suite - 39x23in 990x585mm - Black MT0022	2	Ea	011017432	ADA BLACK TABLE	A	3PL	WH	WEST COAST INDUSTRIES	ADA					F875, J353, U353, Y353	
Furniture	2 - Multiple Item Numbers	12187	Table - Cafe Base - 18x28in - Hot Rolled Steel	8	Ea	011007889	BASE TABLE INTERIOR	A	3PL	WH	WEST COAST INDUSTRIES	HTC 001					F920, J305, U305, Y305	
Furniture	2 - Multiple Item Numbers	12187	Table - Cafe Base - 18x28in - Hot Rolled Steel	8	Ea	011015125	TABLE BASE 28.5X18	A	3PL	WH		12187 28" 710MM					F920, J305, U305, Y305	
Furniture	2 - Multiple Item Numbers	12187	Table - Base Cafe Dome Accent - 18x28in 455x710mm - Hot Rolled Steel MT0011	7	Ea	011007889	BASE TABLE INTERIOR	A	3PL	WH	WEST COAST INDUSTRIES	HTC 001					F920, J305, U305, Y305	
Furniture	2 - Multiple Item Numbers	12187	Table - Base Cafe Dome Accent - 18x28in 455x710mm - Hot Rolled Steel MT0011	7	Ea	011015125	TABLE BASE 28.5X18	A	3PL	WH		12187 28" 710MM					F920, J305, U305, Y305	
Furniture	2 - Multiple Item Numbers	12313	Table - Occasional with T Base Short - Hot Rolled Steel MT0011	4	Ea	011010199	TABLE SIDE T BASE LOW	A	3PL	WH		12313 22X14					F977, J375, U375, Y375	
Furniture	2 - Multiple Item Numbers	12313	Table - Occasional with T Base Short - Hot Rolled Steel MT0011	4	Ea	011018145	TABLE SIDE T BASE LOW	A	3PL	WH		SIDE, T BASE LOW					F977, J375, U375, Y375	
Furniture	7 - Custom Item	0300	FRAME FOR C.O.	4	Ea			A	GC								NA	STAPLES OFFICE SUPPLY
Furniture	7 - Custom Item	0301	Art - Stamps - 38x48in	1	Ea			A	GC								NA	BY GFX, REFER TO CUSTOM CONTACT INFORMATION ON I-802; SAME IMAGES AS MA03 PRINTED ON PLYWOOD
Furniture	7 - Custom Item	0302	ART WORK - 24x27 ESPRESSO	1	Ea			A	GC								NA	BY GFX, REFER TO CUSTOM CONTACT INFORMATION ON I-802
Furniture	7 - Custom Item	0303	ART WORK - 24x24 PIKES PLACE	1	Ea			A	GC								NA	BY GFX, REFER TO CUSTOM CONTACT INFORMATION ON I-802
Furniture	7 - Custom Item	0304	COMMUNITY BOARD - 30x42	1	Ea			A	GC								NA	BY GFX, REFER TO CUSTOM CONTACT INFORMATION ON I-802
Furniture	7 - Custom Item	0305	Window Film	2	Ea			A	VD								NA	By Jim S/Wr Fasara Type: Glass (SH2MAGL) Satin Finish, coordinate with Starbucks CM
Furniture	7 - Custom Item	0300	SS Panel at DT AND WORKROOM	1	Ea			A	VD								NA	Satin Finish, coordinate with Starbucks CM
Furniture	7 - Custom Item	0300	52" MINIKA CONCEPT 1 W/ET LOCATION- BRONZE CEILING FAN - 38055	2	Ea			A	GC								NA	ORDER FROM LAMPSPLUS.COM
LightingFixtures	1 - Success	11258	Strip - Double - 24in 610mm - White	3	Ea	011018743	SURFACE MOUNTED 24" 2 TUBE FL	A		VD				120/220			NA	L581
LightingFixtures	1 - Success	11404	Troffer - Recessed - 48x24in 1220x610mm - White	3	Ea	011014686	LIGHT TROFF RCSD 48X24 WHT-P	A		VD								L663, L666, L988
LightingFixtures	1 - Success	11419	Emergency Light Double - Black	7	Ea	011014847	LIGHT EMERGENCY DOUBLE BLK-P	A		VD								L857
LightingFixtures	1 - Success	11426	Strip - Double - 48in 1220mm - White	3	Ea	011018745	SURFACE MOUNTED 48" 2 TUBE FL	A		VD				120/220			NA	L579
LightingFixtures	1 - Success	11443	Track - Fixture Enclosed - 3.5in 90mm - Black	13	Ea	011014879	LIGHT TRACKHEAD FLARESTP BLK-P	A		VD								L150, L194
LightingFixtures	1 - Success	11521	Track - Fixture Enclosed - 5in 125mm - Black	2	Ea	011014883	LIGHT TRACKHEAD FLARED BLK-P	A		VD								L142
LightingFixtures	1 - Success	11579	Sconce - Restroom Vanity Flowed - 25in - Satin Nickel	7	Ea	011008787	LIGHTING OXYGEN VANITY 2"	A		VD	OXYGEN LIGHTING				Linear Fluorescent - T5	120/277		L715
LightingFixtures	1 - Success	12219	Pendant - Small Glass with Dark Red Stem - Milk Glass GL0001	3	Ea	011008910	PENDANT WHITE OPAL	A		VD	SUZHOU POWERHOUSE	RLSP 003 1 SINGLE TUBE PENDANT				120		L719, J744, U744, Y744
LightingFixtures	1 - Success	12654	FL T8 15w 3000k	8	Ea	011018783	FL TUBE 17WRS TR85	A		VD							0.125	NA
LightingFixtures	1 - Success	12903	LED PAR 20 10w 2700k Short Neck Dim Nfl - Silver	47	Ea	011018183	LED 10W PAR20 SHORT E26 20 DEG	A		VD								NA
LightingFixtures	1 - Success	12905	LED PAR 20 7w 2700k Dim Nfl - Black	37	Ea	011018170	LED 7W PAR20 (BK) E26 20 DEG	A		VD								NA
LightingFixtures	1 - Success	12946	Track - with Connectors - 4ft 122cm - Black	1	Ea	011014657	LIGHT TRACK 4' CNCT KIT BLK-P	A		VD								NA
LightingFixtures	1 - Success	12947	Track - with Connectors - 8ft 244cm - Black	1	Ea	011014881	LIGHT TRACK 8' CNCT KIT BLK-P	A		VD								NA
LightingFixtures	1 - Success	12948	Track - with Connectors - 18ft 488cm - Black	1	Ea	011014680	LIGHT TRACK 18' CNCT KIT BLK-P	A		VD								NA
LightingFixtures	1 - Success	12958	Track - Fixture Open Flared - 5in 125mm - Black	5	Ea	011018637	TRACK FLARED OPEN LG BLACK	A		VD								NA
LightingFixtures	2 - Multiple Item Numbers	11458	Can - Adjustable Recessed Housing - 5in 125mm - New Ceiling	20	Ea	011014656	LIGHT CAN 5" FLSH GIMBAL ADJ-P	A		VD								L357
LightingFixtures	2 - Multiple Item Numbers	11458	Can - Adjustable Recessed Housing - 5in 125mm - New Ceiling	20	Ea	011014689	LIGHT CAN 5" RCSD T2C20R WHT-P	A		VD								L357
LightingFixtures	2 - Multiple Item Numbers	11458	Can - Adjustable Recessed Housing - 5in 125mm - New Ceiling	20	Ea	011017488	5" RCSD FLSH OPN TRM PAR30 NEW	A		VD								L357
LightingFixtures	2 - Multiple Item Numbers	11611	Emergency Exit Light - White	4	Ea	011014851	LIGHT EXT/EMG COMBO WHT/GRN-P	A		VD								L853, L863
LightingFixtures	2 - Multiple Item Numbers	11611	Emergency Exit Light - White	4	Ea	011014852	LIGHT EXT/EMG COMBO WHT/RED-P	A		VD								L853, L863
LightingFixtures	2 - Multiple Item Numbers	12172	Pendant - Small Metal Bullet - Weathered Nickel MT0023	12	Ea	011007991	BULLET PENDANT WEATHERED NICKEL	A		WH	RESOLUTE	HULSP-001 PENDANT BULLET						L700, J732, U732, Y732
LightingFixtures	2 - Multiple Item Numbers	12172	Pendant - Small Metal Bullet - Weathered Nickel MT0023	12	Ea	011008003	PENDANT BLACKENED STEEL 5X10	A		WH	RESOLUTE	HERITAGE ALSP 002						L700, J732, U732, Y732
LightingFixtures	2 - Multiple Item Numbers	12861	Can - Adjustable Recessed Housing - 4in 100mm - New Ceiling	24	Ea	011014655	LIGHT CAN 4" FLSH GIMBAL ADJ-P	A		VD								NA
LightingFixtures	2 - Multiple Item Numbers	12861	Can - Adjustable Recessed Housing - 4in 100mm - New Ceiling	24	Ea	011014671	LIGHTING 1054 BOX-P	A		VD								NA
LightingFixtures	2 - Multiple Item Numbers	12890	FL T8 28w 4100k	15	Ea	011018764	FL TUBE 28W T8 G134100K	A		VD								NA
LightingFixtures	2 - Multiple Item Numbers	12890	FL T8 28w 4100k	15	Ea	011018772	FL TUBE 28W T8 G134100K-CTD	A		VD								NA
LightingFixtures	4 - No Item Number Found	11670	Sconce - 6in Wall Wash with Shield - White	2	Ea			A										L855, L872
LightingFixtures	4 - No Item Number Found	13241	Can - Adjustable Recessed Trim - 4in 100mm - White	24	Ea			A										NA
LightingFixtures	4 - No Item Number Found	13242	Can - Adjustable Recessed Trim - 5in 125mm - White	20	Ea			A										NA
Material	1 - Success	11449	Tile - Diamante - 12x12	19	Sq Ft	000179263	TILE INTERIM 3 DIAMANTE 12X12	A		WH	APICE	INTERIM 3 DIAMANTE 12X12						B012
Material	1 - Success	12226	Tile - Olive Grey Mosaic - 6x24in 150x610mm	245	Sq Ft	011008102	PARC OLIVE MOSAIC	A		VD								B208
Material	1 - Success	12247	Tile - Wood Grain Medium Brown - 8x24in 150x610mm	494	Sq Ft	011008150	BROWN WOODGRAIN TILE 8X24	A		VD								B009, Y518
Material	2 - Multiple Item Numbers	12208	Tile - Brick Red - 2x8in 50x205mm	156	Sq Ft	011008080	SANTOS BRICK RED 2X8	A		VD								B752, J567, Y567, U567
Material	2 - Multiple Item Numbers	12206	Tile - Brick Red - 2x8in 50x205mm	156	Sq Ft	011018536	TILE BRICK RED 2X8IN 50X205MM	A		VD								B752, J567, Y567, U567
Material	4 - No Item Number Found	11302	VINYL ACT	503	Sq Ft			A		GC								T001
Material	4 - No Item Number Found	11363	ACT Segals - 2x2	822	Sq Ft			A		GC								T003
MechanicalEquipment	4 - No Item Number Found	10317	HVAC - Supply Square - 24in	12	Ea			A										H004, H014
MechanicalEquipment	4 - No Item Number Found	10632	Fan - Restroom Exhaust	1	Ea			A										H500, H510
MechanicalEquipment	4 - No Item Number Found	10663	Thermostat	2	Ea			A										H501, H511
MechanicalEquipment	4 - No Item Number Found	10718	HVAC - Supply 2 Way Hard Lid Square - 12in	2	Ea			A										H001, H011
MechanicalEquipment	4 - No Item Number Found	10973	Fan - Restroom Exhaust Roof Curb and Damper	2	Ea			A										H700, H701, H710, H711
MechanicalEquipment	4 - No Item Number Found	11121	HVAC - Return 2 Way Lay In Square - 24in	4	Ea			A										H005, H015
PlumbingFixtures	1 - Success	10116																

Address 54781-001  
 Store Name Rayzor Ranch  
 Store Number 16766  
 Project Type NEVFU  
 2320 University Drive  
 Address Denton, TX 76207  
 United States

Alternate Address

Category	Mapping Status	Design ID	Revit Description	Qty	Unit of Meas	Item Number	Item Description	Item Status	Responsibility	Stocking Status	Manufacturer	Model #	Bulb	Volts	Watts	Amp	Old Tag	Comments
Plumbing/Fixtures	2 - Multiple Item Numbers	10804	Faucet - 3 Comp Sink with Swing Spout	1	Ea	000182203	FAUCET 1/4IN WORKROOM ADD-ON	A	3PL	WH	COMPONENT HARDWARE GROUP INC	14" WORKROOM ADD-ON FAUCET					P360	
Plumbing/Fixtures	2 - Multiple Item Numbers	10804	Faucet - 3 Comp Sink with Swing Spout	1	Ea	011018148	FAUCET PRERINSE LEAD COMPLIANT	A	3PL	WH	COMPONENT HARDWARE GROUP INC	14" WORKROOM ADD-ON FAUCET COMPLIANT					P360	
Plumbing/Fixtures	4 - No Item Number Found	10309	Drain - Floor Sink with Half Grate Square - 12in	6	Ea												P035	
Plumbing/Fixtures	4 - No Item Number Found	11109	Water Heater 50gal Electric	1	Ea					GC							P811	
Plumbing/Fixtures	4 - No Item Number Found	12501	Filter - MRS System 800gpd	1	Ea					SB							NA	
Plumbing/Fixtures	4 - No Item Number Found	12551	Toilet - Tankless Efficient Single Flush	2	Ea													
Plumbing/Fixtures	4 - No Item Number Found	13063	Toilet - Flush Valve Manual Efficient	2	Ea													
Plumbing/Fixtures	4 - No Item Number Found	13076	Filter - Prefiltration System	1	Ea													
Plumbing/Fixtures	4 - No Item Number Found	13085	Filter - Prefiltration Cartridge	1	Ea													
Railings	1 - Success	11361	Tile Base - Bianco - 6x12	4	BX	000178252	TILE 6X12 BIANCO BASE	A	SB	WH	APICE	BIANCO BASE 6X12					B050	Grout - Mapei D9 - Grey
Railings	1 - Success	12197	Tile Base - Rust Brown - 6x12in 150x305mm	187	Rt	011008013	PARKLAND REDWOOD BASE 6X12	A	VD	VD		PARKLAND REDWOOD BASE 6X12					B801	Grout Specification 007, Mapei 47 - Charcoal; Latitecra 35.9Mocha
Railings	1 - Success	12814	Vinyl - Wall Covering - Dark Brown Woven Pattern - 96in (815) AFF	58	Rt	011011981	WALL COV BURLAP LOOK DRK BRWN	A	VD	VD		12814 VINYL BURLAP LOOK DARK BROWN					G091, J613, Y613, U613	
Railings	2 - Multiple Item Numbers	12284	Tile Base - Sandstone - 6x13in 150x330mm	54	Rt	011008151	VERANDA GRAVEL COVE BASE 6X13	A	SB	VD		VERANDA GRAVEL COVE BASE 6X13					B907	Grout Specification 005, Mapei 19 - Pearl Grey; Latitecra 34.4Sandstone
Railings	2 - Multiple Item Numbers	12284	Tile Base - Sandstone - 6x13in 150x330mm	64	Rt	011018135	TILE BASE 6X13IN MOTTLED BEIGE	A	SB	VD		BASE 6X13IN MOTTLED BEIGE					B907	Grout Specification 005, Mapei 19 - Pearl Grey; Latitecra 34.4Sandstone
Railings	4 - No Item Number Found	12173	Chair Rail - 4in (100mm)	58	Rt												N402	
Site	1 - Success	10046	DT Speaker Post	1	Ea	011018918	DRIVE THRU SPEAKER POST	A	VD	VD		DRIVE THRU SPEAKER POST					S605, S814	See Casework Finish Schedule for Material
Site	1 - Success	10050	DT Pre Menu - Freestanding	1	Ea	011017510	DT FREESTANDING PRE-MENU BOARD	A	VD	VD		DT FREESTANDING PRE-MENU BOARD					S800	
Site	1 - Success	10052	DT 5 Panel Menu - Freestanding	1	Ea	011017514	DT FREESTANDING 5 PANEL MENU	A	VD	VD		DT FREESTANDING 5 PANEL MENU					S802	
Site	1 - Success	13157	Sign - Disk DF Illuminated Suspended Evolved - 24in 610mm	1	Ea	011018739	DISK 24IN DF ILLUM UPPR MOUNT	A	VD	VD		DISK DF ILLUMINATED UPPER MOUNT 24IN					NA	
Site	1 - Success	13166	Sign - DT Directional DF Illuminated with Logo Evolved - 30in 762mm	4	Ea	011018785	DIR 30IN DF W/LOGO ILLUM	A	VD	VD		DIRECTIONAL DF ILLUMINATED W LOGO 30IN					NA	
Site	2 - Multiple Item Numbers	10047	Sign - DT Clearance Bar Freestanding - 10x13ft	1	Ea	011012555	PBI SIGN CLRCEBAR FRSTD 10X13	A	VD	VD		10047 DT CLEARANCE BAR FREESTANDING - 10X13FT					S613	
Site	2 - Multiple Item Numbers	10047	Sign - DT Clearance Bar Freestanding - 10x13ft	1	Ea	011012839	PBI SIGN CLRANCE BAR FRSTD 10X1	A	VD	VD		10047 DT CLEARANCE BAR FREESTANDING - 10X13FT					S613	
Site	2 - Multiple Item Numbers	11169	Sign - Drive Thru SF Illuminated Flush Mounted - 62in 1575mm	2	Ea	011012562	PBI SIGN DT SF ILLUM MTD 62IN C	A	VD	VD		11169 DT SF ILLUMINATED WALL MOUNTED - 62IN					S660	
Site	2 - Multiple Item Numbers	11169	Sign - Drive Thru SF Illuminated Flush Mounted - 62in 1575mm	2	Ea	011012829	PBI SIGN DT SF ILL W/MTD 62IN	A	VD	VD		11169 DT SF ILLUMINATED WALL MOUNTED - 62IN					S660	
Site	2 - Multiple Item Numbers	13162	Sign - Disk SF Illuminated Wall Mounted Evolved - 36in 915mm	2	Ea	011016745	DISK 36IN SF ILLUM WALL MOUNT	A	VD	VD		DISK SF ILLUMINATED WALL MOUNT 36IN					NA	
Site	2 - Multiple Item Numbers	13162	Sign - Disk SF Illuminated Wall Mounted Evolved - 36in 915mm	2	Ea	011016746	DISK 36IN SF ILLUM WALL MOUNT	A	VD	VD		DISK SF ILLUMINATED WALL MOUNT 36IN					NA	
Site	4 - No Item Number Found	10020	DT Window Shelf - 48in - Stainless	1	Ea					GC							D204	
Site	4 - No Item Number Found	10033	Trash - Round - 18in with Ash Urn	1	Ea					SB							M044, M191	
Site	7 - Custom Item	x0700	Sign - IN-LINE ILLUMINATED ON 2" DEEP RACEWAY W/ BRUSHED ALUMINUM BACKER PLATE - 16in	1	Ea					VD							NA	MODIFIED VERSION OF 11423, REFER TO RAYZOR RANCH TENANT CRITERIA MANUAL
Specialty/Equipment	1 - Success	10091	Cup Dispenser Tall Hot Vertical	1	Ea	000194318	DISPENSER CUP TALL HOT VERT	A	3PL	WH	DIVERSIFIED METAL PRODUCTS INC	HOT CUP TALL VERTICAL					M722	
Specialty/Equipment	1 - Success	10099	Restroom Toilet Paper Holder	2	Ea	000181937	DISPENSER TOILET PAPER	A	VD	WH	ASI	TOILET PAPER					M063, M307, M507	
Specialty/Equipment	1 - Success	10110	Fridge Reach In 1 Door RH - 29in	1	Ea	000257005	FRIDGE 1 DOOR TGR1S RIGHT	A	3PL	WH	ASI	TGR1S RIGHT					E421, E356	
Specialty/Equipment	1 - Success	10172	Restroom Seat Cover Dispenser	2	Ea	000181938	DISPENSER TOILET SEAT COVER	A	3PL	WH	ASI	TOILET SEAT COVER					M064, M309	
Specialty/Equipment	1 - Success	10222	Wire Shelf Grid at Sink	2	Ea	000168938	SHELVING GRID FOR 3 COMP SINK	A	SB	WH		WIRE GRID FOR 3 COMP SINK					M072	
Specialty/Equipment	1 - Success	10293	10 Comp Locker	1	Ea	000192267	LOCKER 10 COMPARTMENT	A	SB	WH	STEINER SYSTEM	10 COMPARTMENT					M025, M514, M539	
Specialty/Equipment	1 - Success	10312	Brewer Soft Heat Single Warming Stand	5	Ea	000185672	STAND SH WTRAY SINGLE	A	SB	WH	BUNN O MATIC CORPORATION	27825					E543, E569	
Specialty/Equipment	1 - Success	10314	Scale Digital with Adjustable Display Mount	1	Ea	011004949	SCALE COFFEE BEAN 15 LB	A	SB	WH	METTLER TOLEDO	REMOTE DISPLAY TOWER					E633, E634, E535, E537, E613	
Specialty/Equipment	1 - Success	10344	Ice - Bin Drop In 96lb	1	Ea	000194924	ICE BIN FOR MSS-CBS	A	VD	WH	SPOKANE STAINLESS SSP	MSS-CBS-ICE					P012	
Specialty/Equipment	1 - Success	10389	Cup Dispenser Short Hot Vertical	1	Ea	000194320	DISPENSER CUP SHORT HOT VERT	A	3PL	WH	DIVERSIFIED METAL PRODUCTS INC	HOT CUP SHORT VERTICAL					M721	
Specialty/Equipment	1 - Success	10416	Workroom Wire Shelving	7	Ea	000183294	SHELVING WORKROOM WIRE 18X36 B/C'S	A	SB	WH		WIRE BACKROOM 18X36					M032, M176, M515	
Specialty/Equipment	1 - Success	10439	Cup Dispenser Grande Venti Hot Horizontal	2	Ea	000413499	DISPENSER HORIZ GRANDVENTI HO	A	SB	WH	UNKNOWN	7' BACKROOM POSTS					M034, M134, M533	
Specialty/Equipment	1 - Success	10462	Workroom Wire Shelving Posts	7	Ea	000189815	POSTS 7FT BACKROOM BX4	A	SB	WH		7' BACKROOM POSTS					M033	
Specialty/Equipment	1 - Success	10467	File Cabinet 2 Drawer	1	Ea	000101121	FILE CABINET COMPLETE	A	SB	WH	MARTIN YALE	#K1-101120					M048, M234, M530, F712	
Specialty/Equipment	1 - Success	10473	Fridge Undercounter 2 Door - 48in	1	Ea	000110101	REFRIGERATOR UC 2 DOOR	A	SB	WH	DELFIELD	UC48H-STAR					E201, E327, E330, E334, E408	
Specialty/Equipment	1 - Success	10512	Ice - Machine 120lb Remote Cooled	1	Ea	000190826	ICE MACHINE REMOTE 100#	A	VD	VD	MILE HIGH EQUIPMENT CO	100LB ICE100RH/RC20					E345	
Specialty/Equipment	1 - Success	10524	Wire Shelf Undercounter at Sink	1	Ea	000333413	WIRE SHELF RNA	A	SB	WH		WIRE					M818	
Specialty/Equipment	1 - Success	10527	Ice - Bin Drop In 45lb	1	Ea	000344430	ICE BIN 45#	A	SB	WH		45LB					P392	
Specialty/Equipment	1 - Success	10586	Mop Rack with 3 Holders	1	Ea	000181939	MOP RACK W/3 HOLDERS	A	SB	WH	ASI	MOP WITH 3 HOLDERS					M077, M531	
Specialty/Equipment	1 - Success	10724	Grinder Dispenser	1	Ea	01105668	GRINDER MOTOR 900 115V	A	SB	WH		900 7S STAR					E003, E006, E010, E020, E037, E038, E041	
Specialty/Equipment	1 - Success	10757	Cup Dispenser Tall Cold Horizontal	5	Ea	000413503	DISPENSER HORIZ TALL COLD	A	SB	WH	UNKNOWN	M238						
Specialty/Equipment	1 - Success	10788	Cup Dispenser Tall Hot Horizontal	1	Ea	000413501	DISPENSER HORIZ TALL HOT	A	SB	WH	UNKNOWN	M135, M236, M534						
Specialty/Equipment	1 - Success	10797	Pastry Case with Self Serve - 66in - Bronze	1	Ea	000181804	FOOD CASE A WINSERT 66IN	A	SB	WH		66" INSERT SB5786					E339, E402	
Specialty/Equipment	1 - Success	10829	Corner Guard - 1.25in - Pewter	5	Ea	000159409	CORNER GUARD METAL 4/SET PEWTR	A	GC	WH	BFC ARCHITECTURAL METALS INC	METAL PEWTER					M089	
Specialty/Equipment	1 - Success	10855	Cup Dispenser Grande Venti Hot Vertical	2	Ea	000194322	DISP CUP GRANDEVENTI HOT VERT	A	SB	WH	DIVERSIFIED METAL PRODUCTS INC	HOT CUP GRANDE VENTI VERTICAL					M223	
Specialty/Equipment	1 - Success	10856	Brewer Soft Heat Server	7	Ea	000185974	SOFT HEAT SERVER GRV	A	SB	WH	BUNN O MATIC CORPORATION	27850 0021					E807	
Specialty/Equipment	1 - Success	10859	Restroom Grab Bar - 48in	2	Ea	000181935	GRAB BAR 1-1/4"X48"	A	3PL	WH	ASI	GRAB BAR 1-1/4"X48"					M058, M304, M505, M537	
Specialty/Equipment	1 - Success	10862	Restroom Grab Bar - 36in	2	Ea	000181936	GRAB BAR 1-1/4"X36"	A	3PL	WH	ASI	GRAB BAR 1-1/4"X36"					M060, M305	
Specialty/Equipment	1 - Success	10907	Dishwasher Legs and Sink	1	Ea	000110640	KIT LEGS SINK BIN LX DSHWASH	A	SB	WH		LX					E809, E816	
Specialty/Equipment	1 - Success	10947	Soap Dispenser Wall Mounted	1	Ea	000181933	SOAP DISPENSER WALL MOUNTED	A	3PL	WH	ASI	SOAP WALL MOUNTED					M053, M303, M506	
Specialty/Equipment	1 - Success	10977	Paper Towel Dispenser Full Size - Translucent Grey	3	Ea	000375374	TOWEL DISPENSER FULL SIZE	A	3PL	WH		TOWEL FULL SIZE					M052, M509, M056	
Specialty/Equipment	1 - Success	10982	Paper Towel Dispenser Half Size - Translucent Grey	1	Ea	000375372	TOWEL DISPENSER HALF SIZE	A	SB	WH		TOWEL HALF SIZE					M055, M155, M508	
Specialty/Equipment	1 - Success	11005	DT Wire Rack Channel Mounted	1	Ea	000168939	SHELF DRIVE THRU ONLY	A	SB	WH		WIRE SHELF DRIVE THRU ONLY					M071	
Specialty/Equipment	1 - Success	11055	Cup Dispenser Grande Venti Cold Horizontal	2	Ea	000413502	DISPENSER HORIZ GRANDVENTI CO	A	SB	WH	UNKNOWN	M237						
Specialty/Equipment	1 - Success	11070	Dishwasher Sanitizer	1	Ea	000181987	DISHWASHER LXIH 208-240V	A	SB	WH	HOBART CORPORATION	120/208-240V					E451, E453, E454, E455, E456, E457, E458, E459, E460, E461	
Specialty/Equipment	1 - Success	11083	Fridge Reach In 2 Door - 51x35in	1	Ea	000247028	FRIDGE REACHIN 2 DOOR T52R2S	A	3PL	WH		T52R 2S					E422	
Specialty/Equipment	1 - Success	11104	10 Comp Locker	1	Ea	000134335	LEG KIT FOR 10 COMPARTMENT LOC	A	SB	WH	STEINER SYSTEM	10 COMPARTMENT LEG KIT					M021	
Specialty/Equipment	1 - Success	11115	Restroom Soap Dispenser Sink Mounted	3	Ea	000181934	SOAP DISPENSER LAVATORY MNTD	A	GC	WH	ASI	LAVATORY SOAP MOUNTED					M054, M524, M954	
Specialty/Equipment	1 - Success	11137	Cup Dispenser Short Hot Horizontal	5	Ea	000413500	DISPENSER HORIZ SHORT HOT	A	SB	WH		ECL-NM34F					M035	
Specialty/Equipment	1 - Success	12073	Sugar Dispenser SST - 17in	1	Ea	011011451	SD FIX DISPENSER 12073 SUGAR S	A	VD	VD		12073 SUGAR SS 17IN					M	